



54/29-33 Corella Road KIRRAWEE NSW

1 1

This one bedroom villa offers an opportunity to downsize to low maintenance, single level living. Located in a whisper quiet family friendly street, walking distance to both Kirrawee and Gymea Village sits this low maintenance quaint one bedroom villa.

Featuring:

- Spacious bedroom offers a built in wardrobe
- Open plan living area with neat & tidy kitchen
- Reverse cycle air conditioning in lounge room
- Neat bathroom & laundry flows to clothesline
- Unallocated parking plus ample street parking
- Close to Kirrawee & Gymea shops & transport

APPLY ONLINE by entering this link into your browser:
[t-app.com.au/c21gynea](https://www.jreproperty.com.au/c21gynea)

[For full version visit the website](https://www.jreproperty.com.au/c21gynea)

Type : Villa

View : <https://www.jreproperty.com.au/lease/nsw/sutherland/kirrawee/residential/villa/7487485>

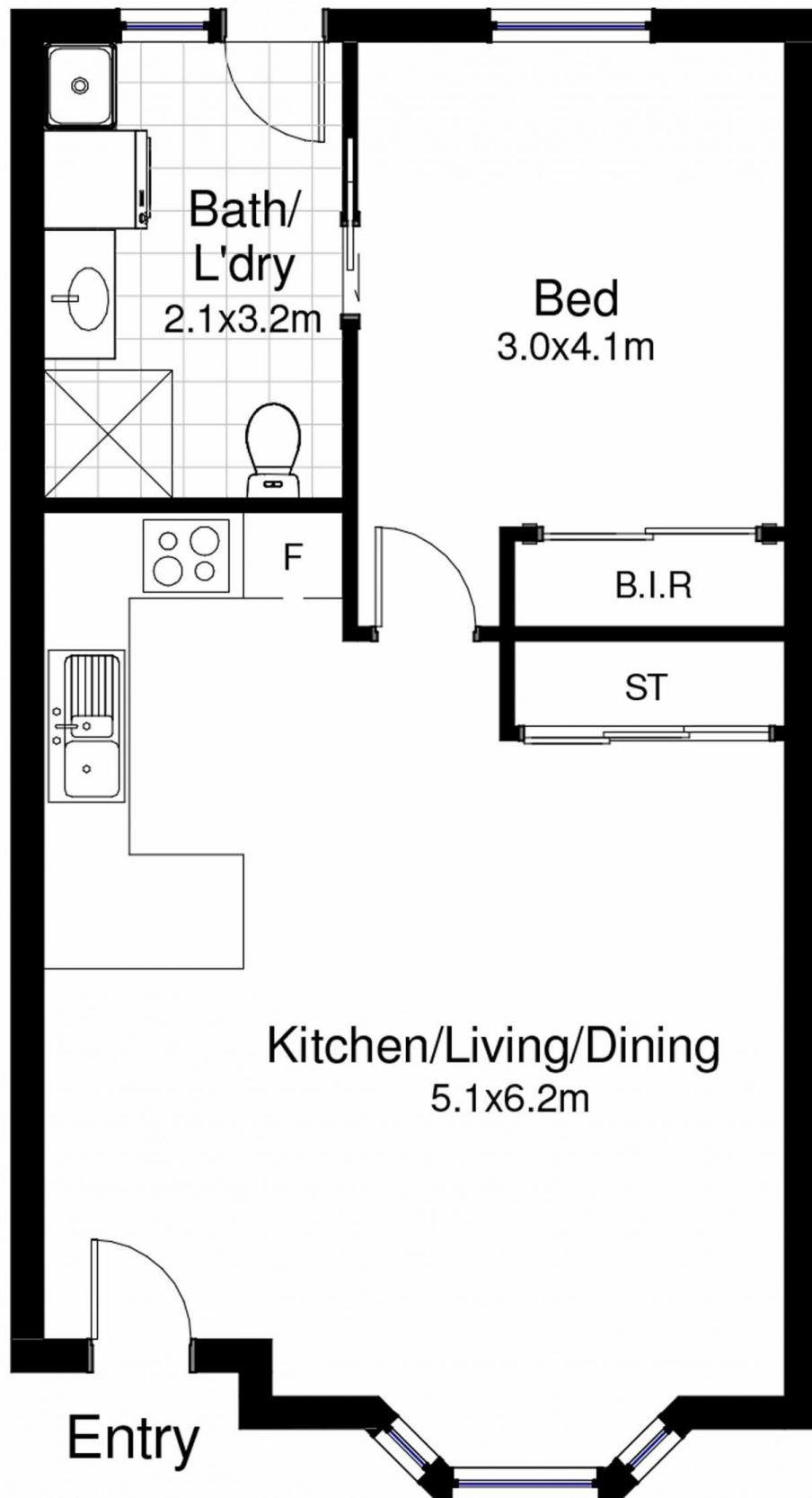

54/29-33 Corella Road, Kirrawee

DISCLAIMER: This is for illustrative purposes only. All dimensions are approximate and it does not constitute part of any legal documents.