



23/125-129 Oak Road KIRRAWEE NSW

2  1  1 

Light, bright and extremely convenient, this well presented apartment boasts a premium top floor setting in the low-rise security building. The well regarded 'Sherwood' complex is just a few metres stroll to Oak Road village, bus and Kirrawee rail.

Type : Unit

View : <https://www.jreproperty.com.au/lease/nsw/sutherland/kirrawee/residential/unit/7487530>

Featuring:

- East facing aspect, leafy streetscape vistas
- Combined living and dining, side balcony
- Tidy good-sized kitchen, electric appliances
- Generous master bed with mirrored robe
- Freshly painted and brand new carpet
- Choice of 2nd bed or study, lock up garage

APPLY ONLINE by entering this link into your browser:

[For full version visit the website](https://www.jreproperty.com.au)

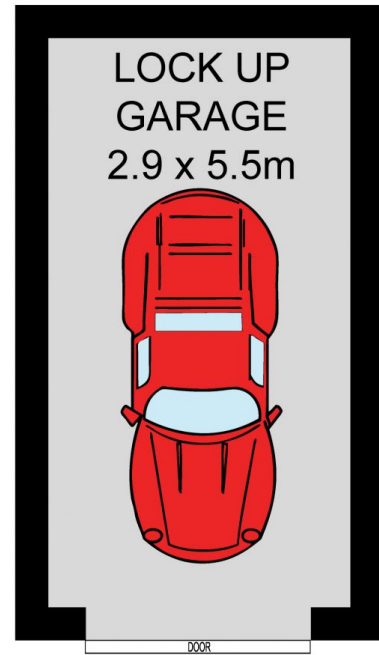
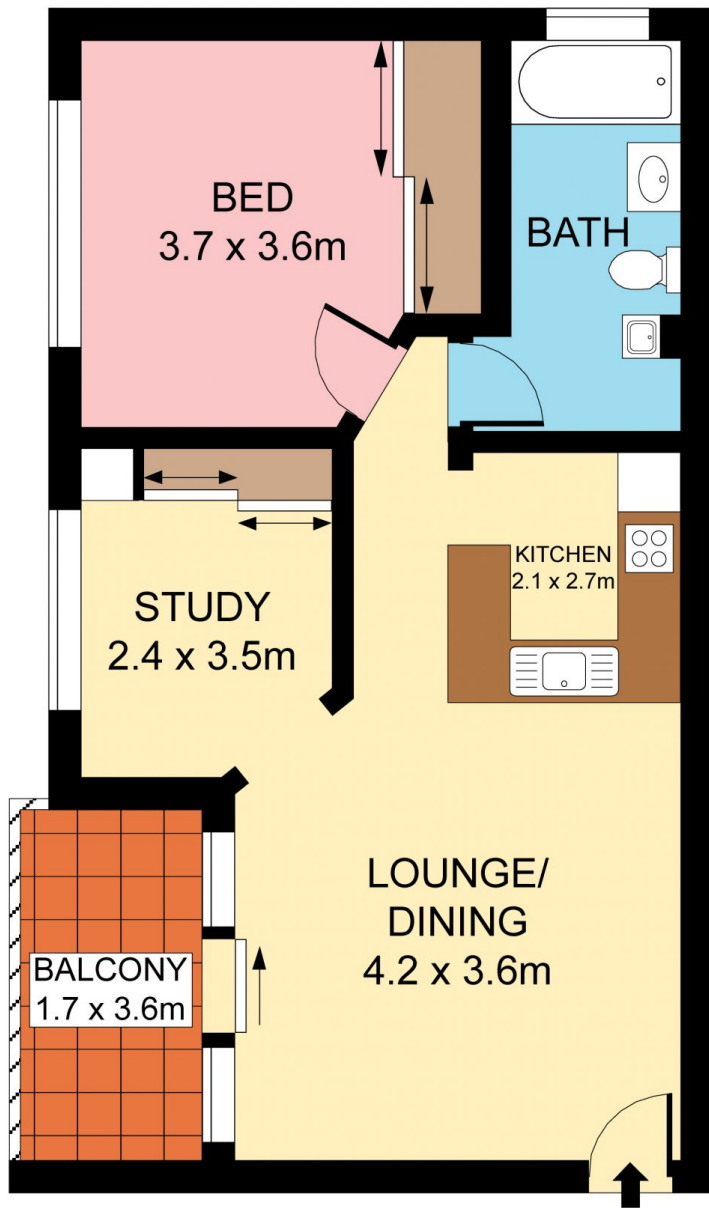

TOP FLOOR



Plans shown are for presentation purposes only and are not part of any legal document or title. They are subject to errors, omissions, inaccuracies and should not be used as a sole and accurate reference. Interested parties should make their own inquiries using independent sources.

23/125-129 OAK ROAD

KIRRAWEE