



83 Ellesmere Road GYMEA BAY NSW

4 2 2

Beyond the uniquely contemporary facade you will immediately begin to appreciate the exquisite tastes & style incorporated into this brand new home. Built in the heart of sought after GyMEA Bay to take full advantage of natural light & a sun drenched north facing backyard. Sure to tick each & every box any family could aspire to, comprising of an open plan lounge & dining adjoining a stunning & super functional kitchen complete with serverly outside to an alfresco entertaining area for those who like to impress, plus another living area downstairs. Upstairs boasts very generous size bedrooms (main with ensuite & walk in robe) & tastefully completed main bathroom plus an additional upstairs retreat. It would yet to be complete if it didnt offer a double lock up garage with internal access not to mention a bus stop across the road, all whilst being in both GyMEA

Type : House

View : <https://www.jreproperty.com.au/sale/nsw/sutherland-gyMEA-bay/residential/house/7488111>



Luke Jeffree
02 9540 2222

[For full version visit the website](https://www.jreproperty.com.au)

Gymea Bay

83 Ellesmere Road

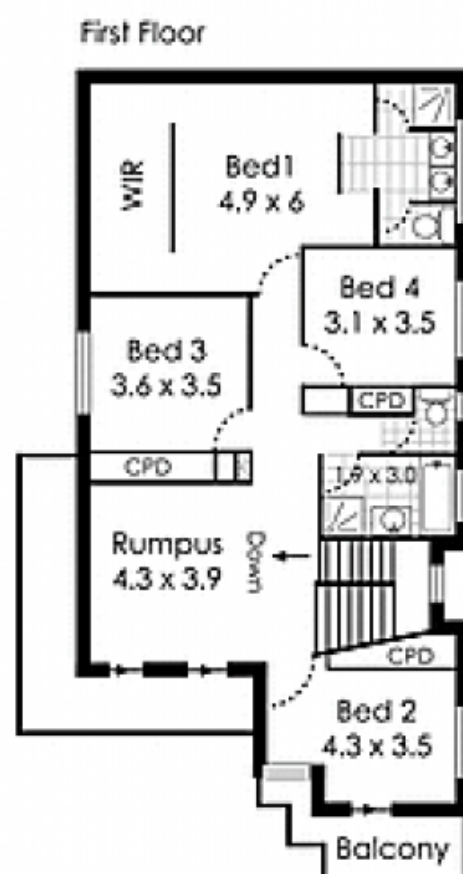
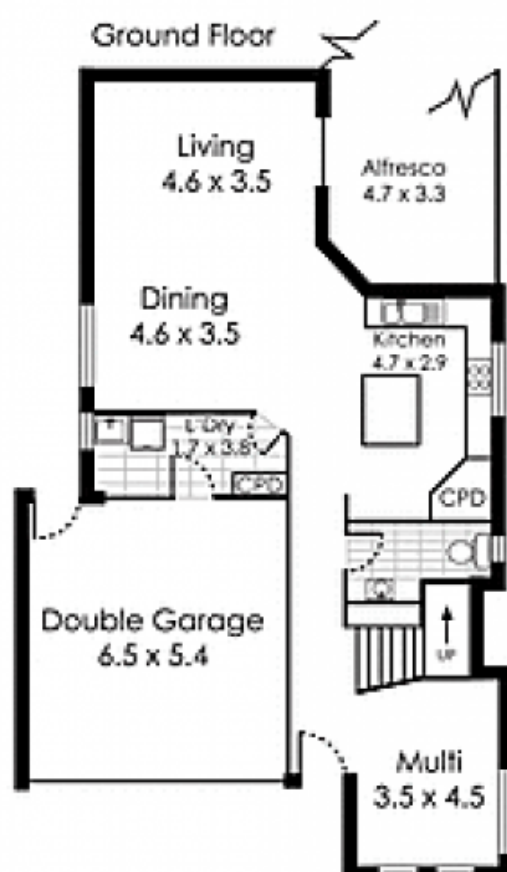

Please note: all stated dimensions are approximate only. Particulars given are for general information only and do not constitute any representation on the part of the vendor or agent.