

93 Bunarba Road GYMEA BAY NSW

4 3 2

Boasting a contrasting mixture of stunning contemporary lines throughout the naturally bright living areas & charming country like exterior provides a uniquely sensational opportunity. This generous 817sqm block enjoys an abundance of sunshine especially on the north facing in-ground pool which adjoins plenty of secured grass & garden area for the kids & pets to play. Downstairs offers a stunning new kitchen, large lounge & dining, media room, massive parents retreat, feature bathroom plus another bedroom. Whilst upstairs has a terrific size teenagers retreat complete with bathroom plus & great size bedroom. Garaging plus off street parking is ideal for those with a boat/caravan. This is truly magnificent & very worthy of your inspection.

Type : House

View : <https://www.jreproperty.com.au/sale/nsw/sutherland-gymea-bay/residential/house/7488122>



Luke Jeffree
02 9540 2222

93 Bunarba Rd
Gymea Bay

This plan is for illustrative purpose only, dimensions are approximate it does not constitute part of any legal document or commercial contract for the sale of this property.
Floor plan by Spinx Australia



GROUND LEVEL

0 1m 5m

FIRST LEVEL

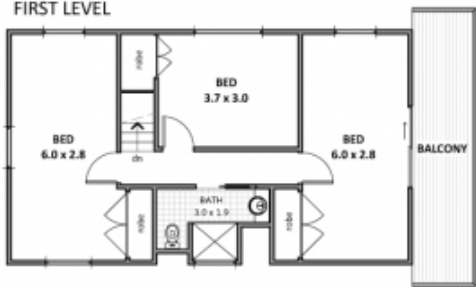

SITE PLAN

