



19 Vernon Avenue GYMEA BAY NSW

3 3 2

A summer of fun and family awaits in this split level home with space to grow and a few nice surprises!

Set in established, low maintenance gardens, beautiful brick and greenery welcomes you through the sheltered entrance.

Step inside to an instantly welcoming vibe, punctuated with timber and brick.

Follow stone tiles down to the open plan kitchen, dining area and family room, and instantly imagine memorable summers

From the kitchen through the living area, experience lifestyle on every level
a sheltered outdoor entertainment and dining area, over

Type : House

View : <https://www.jreproperty.com.au/sale/nsw/sutherland-gymea-bay/residential/house/7488159>



Luke Jeffree
02 9540 2222

[For full version visit the website](https://www.jreproperty.com.au)

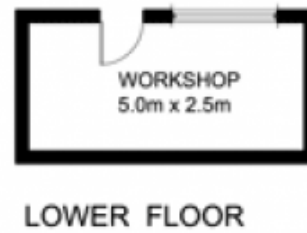

**19 VERNON AVENUE
GYMPEA BAY**

ALL MEASUREMENTS ARE APPROXIMATE

Whilst every attempt has been to ensure the accuracy of the floor plan contained here, measurements of doors, windows, rooms and any other items are approximate only and no responsibility is taken for any error, omission, or misstatement. This plan is for illustrative purposes only and should be used as such by any prospective purchaser. The services, systems and appliances shown have not been tested and no guarantee as to their operability or efficiency can be given. Marked fireplaces may be inactive. Rooms with cupboards and wardrobes are measured wall to wall and may exclude wardrobe and cupboard measurements.