



**7/81-83 Manchester Road GYMEA NSW**

3 2 2

Offered to the market for the very first time, this big townhouse (187sqm) is positioned at the rear of a small complex, just moments to Gymeas shops and train station. Freshly painted and carpeted throughout, the perfectly maintained living spaces feature a modern kitchen, open plan lounge and dining room, generous bedrooms and a sunny rear courtyard. Be very quick!

Open plan lounge & dining room flows to rear courtyard  
Modern kitchen with granite benches, s/s appliance, gas cooking

Generous bedrooms with BIRs, master with en-suite

Modern bathrooms plus third wc to internal laundry

Massive two car garage, internal storeroom, small security complex

**Type** : Townhouse  
**Land Size** : 187 sqm  
**View** : <https://www.jreproperty.com.au/sale/nsw/sutherland/gyMEA/residential/townhouse/7488269>

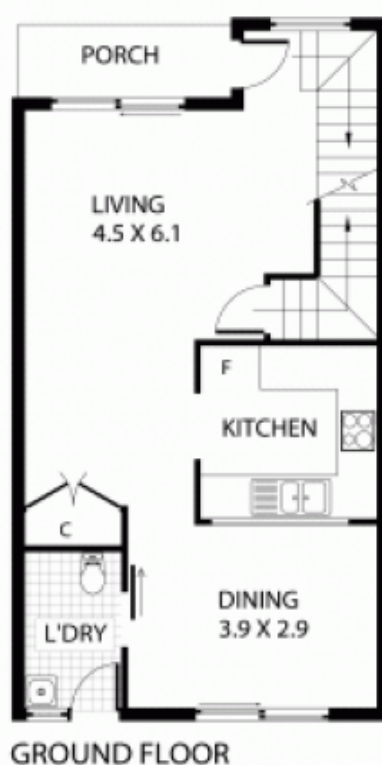

Plans shown are for presentation purposes only and are not part of any legal document or title. They are subject to errors, omissions, inaccuracies and should not be used as a sole and accurate reference. Interested parties should make their own inquiries using independent sources.

**7/81 MANCHESTER ROAD**

**GYMEA**