



11/22 Premier Street GYMEA NSW

2 2 2

Designed for those seeking a convenient and easy living lifestyle, this modern town home is privately located in a stylish security complex. Well proportioned interiors spread over two levels are complimented by a generous courtyard and long balcony. Open plan lounge & dining flows to adjoining courtyard. Contemporary granite kitchen with stainless appliances. Two over sized bedrooms with BIRs, master with ensuite. Both beds adjoin deck, internal access to secure garage. Powder room on 1st level, laundry, storage, air & intercom. Ultra convenient location - a stroll to shops, train & schools.

Type : Townhouse
Building Size : 20 sqm
View : <https://www.jreproperty.com.au/sale/nsw/sutherland/gyMEA/residential/townhouse/7488286>



Luke Jeffree
02 9540 2222

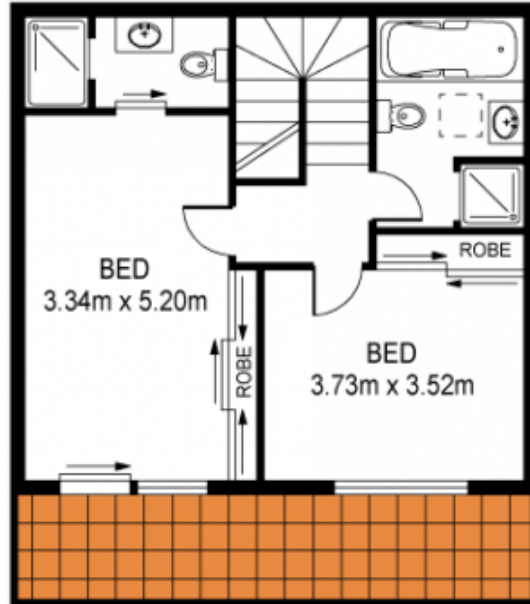

FIRST FLOOR

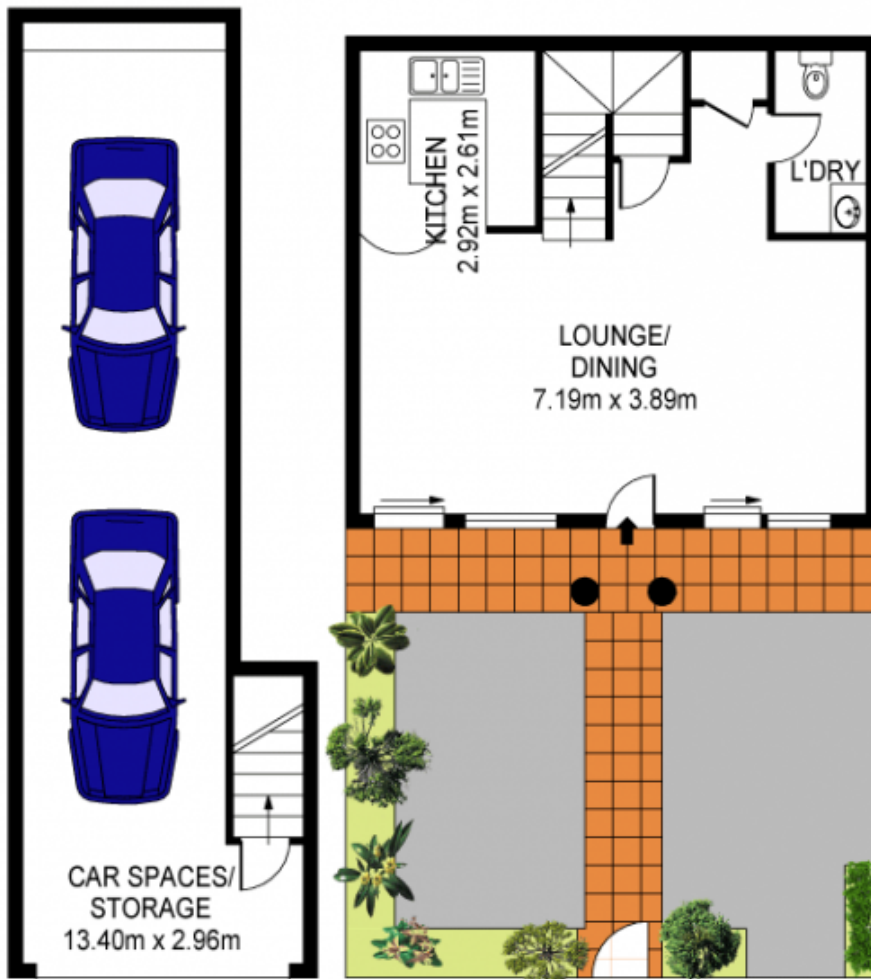

LOWER GROUND FLOOR

GROUND FLOOR

11/22 PREMIER STREET, GYMEA

Plans shown are for presentation purposes only and are not part of any legal document or title and are subject to errors, omissions, inaccuracies and should not be used as sole and accurate reference. Interested parties should make their own enquiries using other sources supplied.