



**260 President Avenue MIRANDA NSW**

3 1 1

Under capitalised, this well maintained three bedroom home, is perfectly comfortable as is, with plenty of potential to add value at a later date. Set on a spacious flat block, this single level home enjoys a lifestyle of convenience just minutes to a wide range of amenities and beautiful beaches and bays. A flexible layout and very private and secure child / pet friendly rear yard are ideal for the family.

High ceilings, timber floors & decorative cornices add charm

Spacious open plan lounge & dining with gas bayonet & air  
Large modern kitchen with abundant cupboard & bench space

All beds with built in robes, main with adjoining study/sunroom

Single lock up garage, shed & storage, ample off street

**Type** : House  
**Land Size** : 556 sqm  
**View** : <https://www.jreproperty.com.au/sale/nsw/sutherlandland/miranda/residential/house/7488290>



**Luke Jeffree**  
**02 9540 2222**

[For full version visit the website](https://www.jreproperty.com.au)

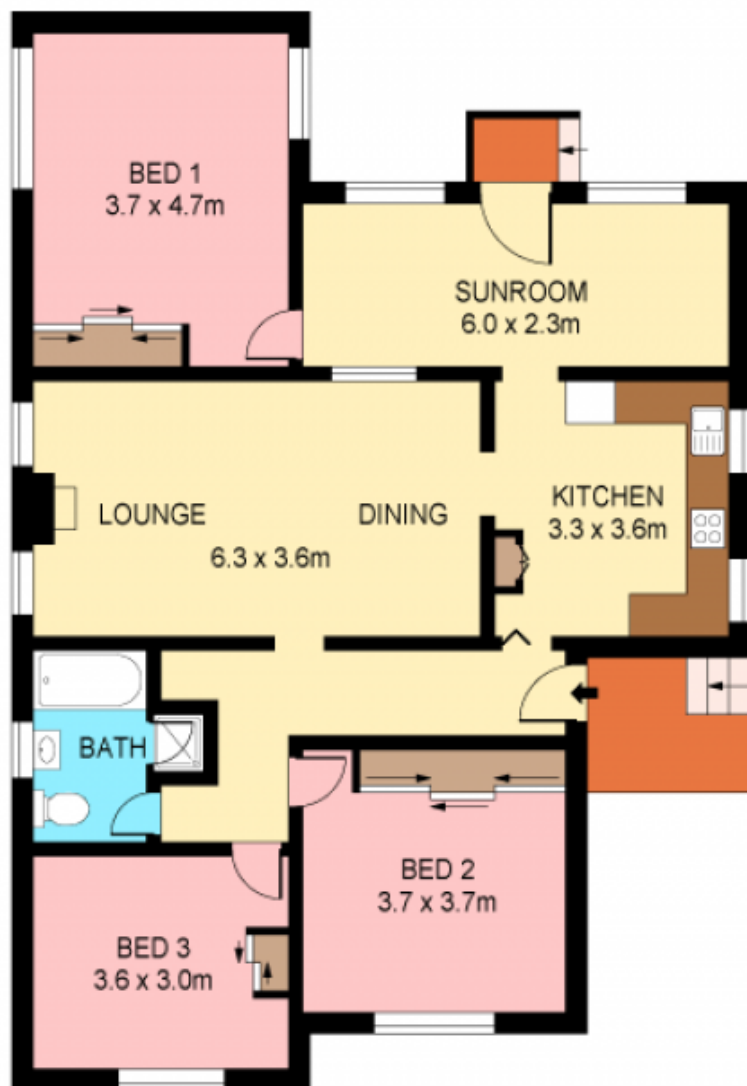

**GROUND FLOOR**



Plans shown are for presentation purposes only and are not part of any legal document or title.  
 They are subject to errors, omissions, inaccuracies and should not be used as a sole and accurate reference.  
 Interested parties should make their own inquiries using independent sources.  
 Ref. No. 9037



260 PRESIDENT AVENUE

MIRANDA