



4/721 Kingsway GYMEA NSW

2 1 1

Located within a stylish security complex surrounded by lush gardens and meandering walkways, this ground floor apartment offers a modern, easy care living environment featuring generous interiors, leafy deck and contemporary appointments. Offering tremendous appeal as an ideal first home or investment, its just a quick stroll to local shops, Tafe, Hazelhurst Art Gallery and Gymea train.

Price : \$ 425,000
Land Size : 104 sqm
View : <https://www.jreproperty.com.au/sale/nsw/sutherlandland/gymea/residential/unit/7488301>

Convenient ground floor garden location, leafy outlook
 Timber floors, open plan living flows to corner balcony
 Modern kitchen with timber cabinets & stainless appliances
 Two bedrooms with built in robes, well presented bathroom
 Appealing feature walls, large laundry with second toilet
 Secure basement garage with internal access to foyer
 Well located quality building with side street access



Luke Jeffree
02 9540 2222

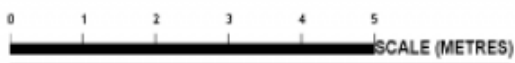
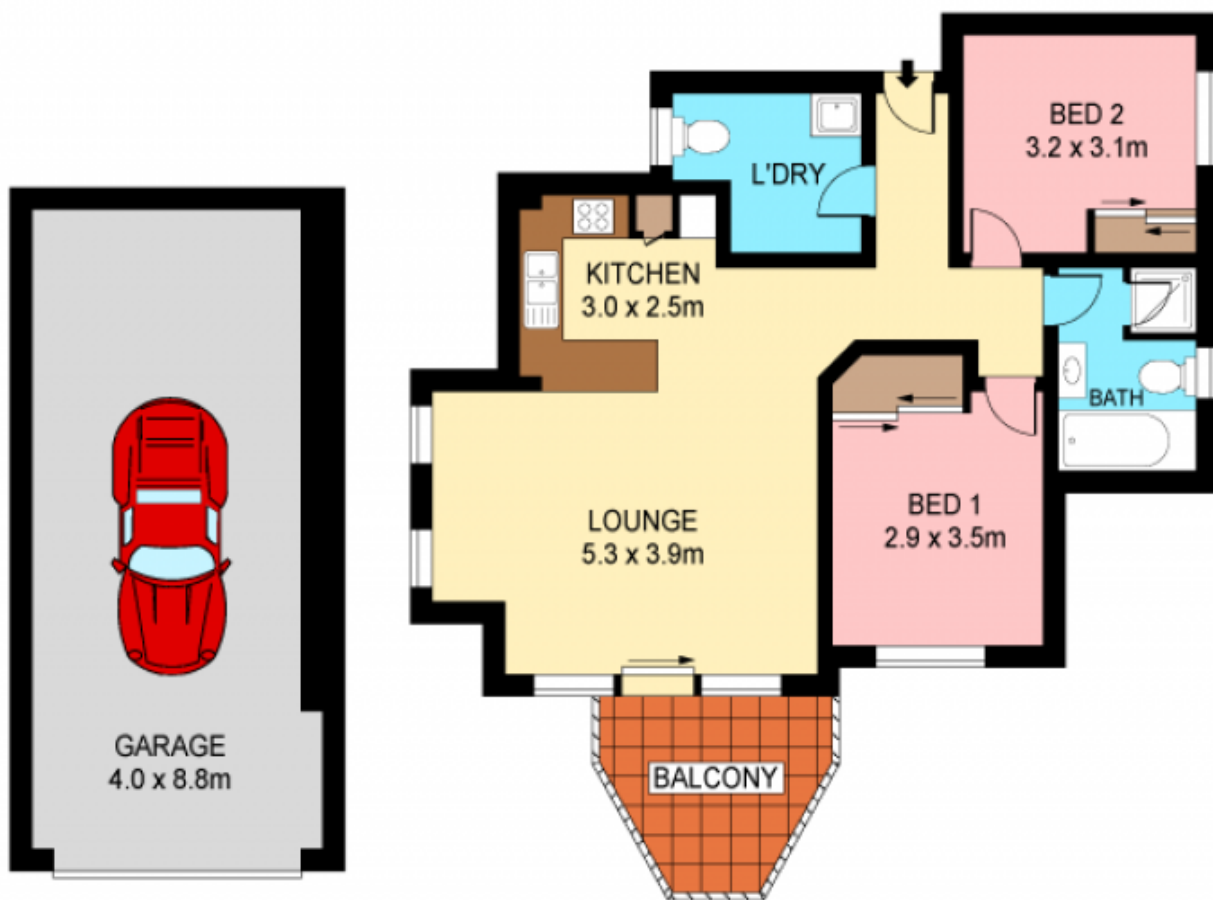

Plans shown are for presentation purposes only and are not part of any legal document of title. They are subject to errors, omissions, inaccuracies and should not be used as a sole and accurate reference. Interested parties should make their own inquiries using independent sources.
Ref. No: 10259

