



**35 Vernon Avenue GYMEA BAY NSW**

3 2 2

Showcasing cottage charm, desirable flexibility and a superb family friendly environment, Jindanulla is perfectly designed to suit a young or growing family. Set back from the road on a generous 1069sqm lot, the home embraces its tranquil surrounds and northerly aspect offering spectacular indoor/outdoor entertaining and picturesque leafy views.

**Type** : House  
**Land Size** : 1069 sqm  
**View** : <https://www.jreproperty.com.au/sale/nsw/sutherland/gymea-bay/residential/house/7488338>

- Polished timber floors throughout, light & bright interiors
- Open plan living with fire opens onto enormous North facing covered deck
- Central kitchen with servery and Smeg freestanding oven
- Versatile studio with laundry & toilet ideal for home business
- Main bed with ensuite, reverse cycle air, child friendly

[For full version visit the website](#)



**Luke Jeffree**  
02 9540 2222

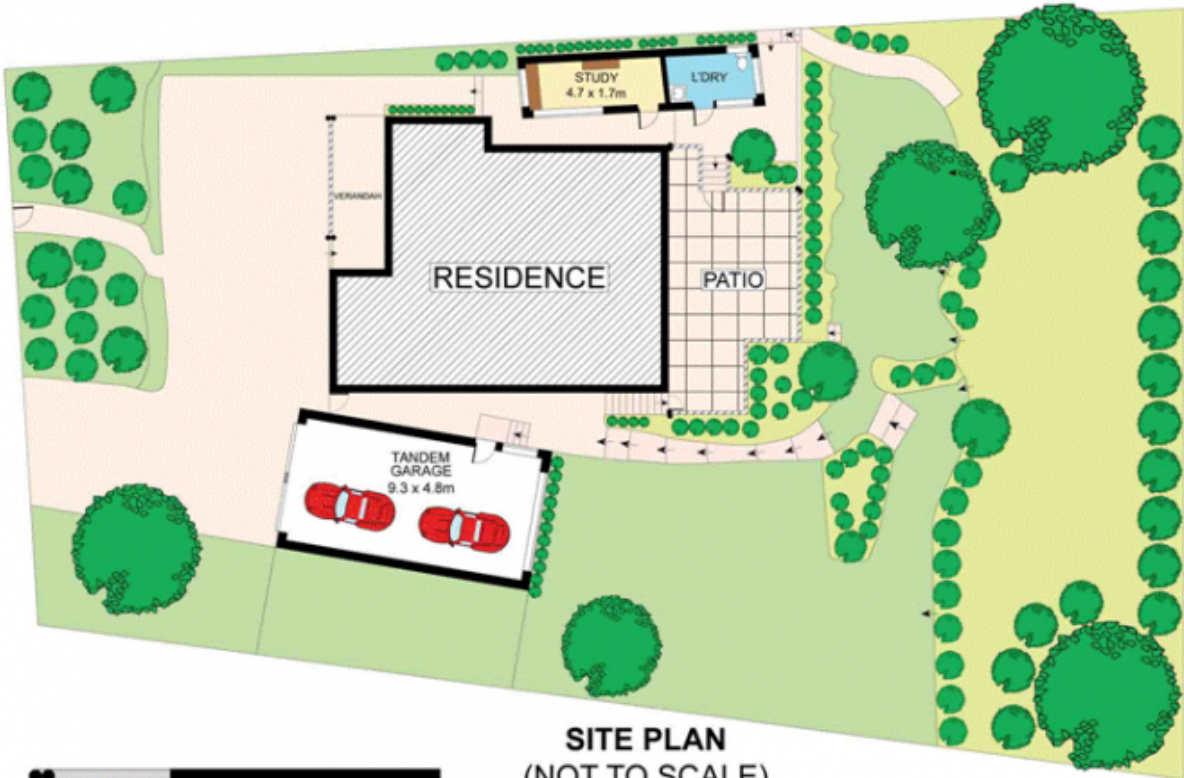

**SITE PLAN**  
(NOT TO SCALE)



**GROUND FLOOR**



Plans shown are for presentation purposes only and are not part of any legal document or title. They are subject to errors, omissions, inaccuracies and should not be used as a sole and accurate reference. Interested parties should make their own inquiries using independent sources.