



### 15 Plover Street GRAYS POINT NSW

3 1 1

Set within the relaxed family friendly enclave of Grays Point, this solid brick family home enjoys an elevated corner location with picturesque vistas across the pristine bushland of the national park. Well maintained and comfortable it presents an appealing entry level option or sound investment with ample scope to further enhance.

- Quiet cul-de-sac, alfresco terrace and deck embrace the views
- Timber floors, spacious family living room with reverse cycle air
- Stylish modern kitchen, central island bench, abundant storage
- Large casual dining, covered patio, private rear alfresco terrace

**Type** : House

**View** : <https://www.jreproperty.com.au/sale/nsw/sutherland/grays-point/residential/house/7488342>



**Luke Jeffree**  
**02 9540 2222**

[For full version visit the website](https://www.jreproperty.com.au)

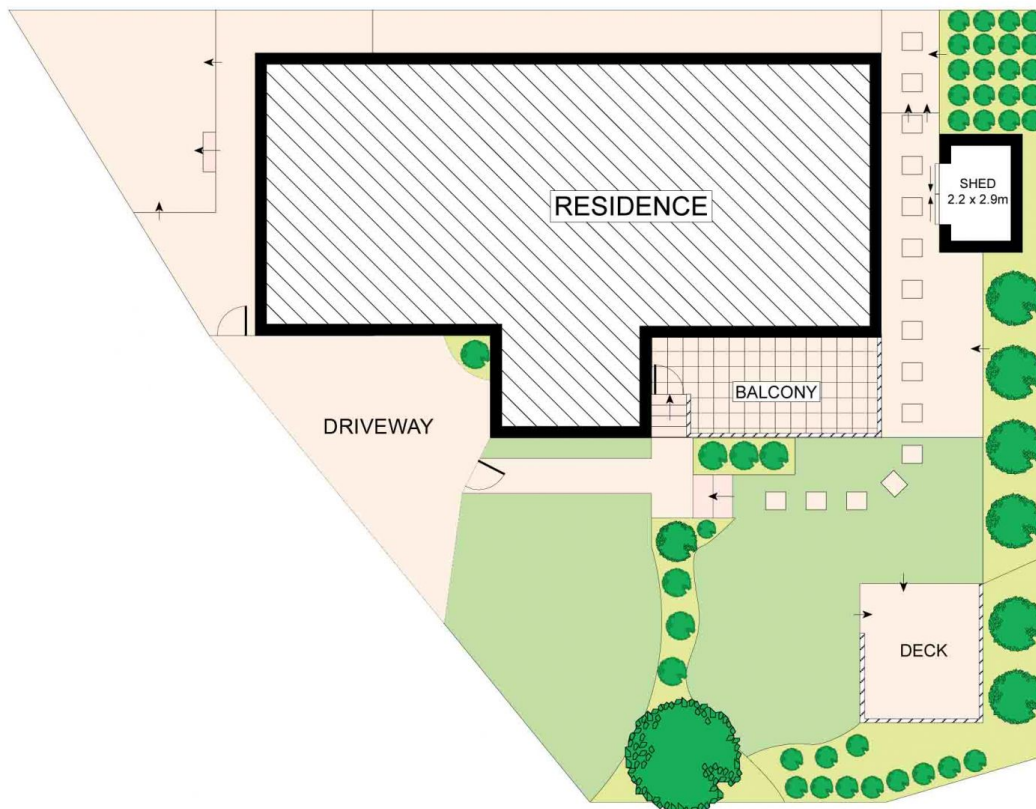

**SITE PLAN (NOT TO SCALE)**



**GROUND FLOOR**



Plans shown are for presentation purposes only and are not part of any legal document or title. They are subject to errors, omissions, inaccuracies and should not be used as a sole and accurate reference. Interested parties should make their own inquiries using independent sources.

**15 PLOVER STREET**

**GRAYS POINT**