

10 Vernon Avenue GYMEA BAY NSW

4 2 2

Embrace exceptional contemporary living in this inviting home, renovated with tasteful style and panache to comfortably accommodate a growing family and provide utmost peace and privacy. The substantial floor plan incorporates multiple living areas, covered outdoor entertaining and desirable flexibility to suit all family needs.

- Spacious open plan lounge & dining, covered alfresco terrace
- Quality kitchen with lavish mother of pearl inlaid benches
- Home office, upper level with 3 large beds, all with robes
- Master bed with his and hers robe and designer ensuite
- Rumpus & 4th bed, suit extended family or home business
- Powder room, ducted air, abundant storage, level lawns

[For full version visit the website](https://www.jreproperty.com.au)

Type : House
Land Size : 834 sqm
View : <https://www.jreproperty.com.au/sale/nsw/sutherland/gymea-bay/residential/house/7488355>



Luke Jeffree
02 9540 2222

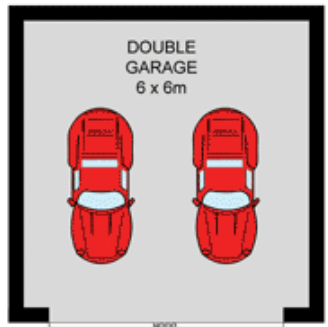

ENTRY LEVEL

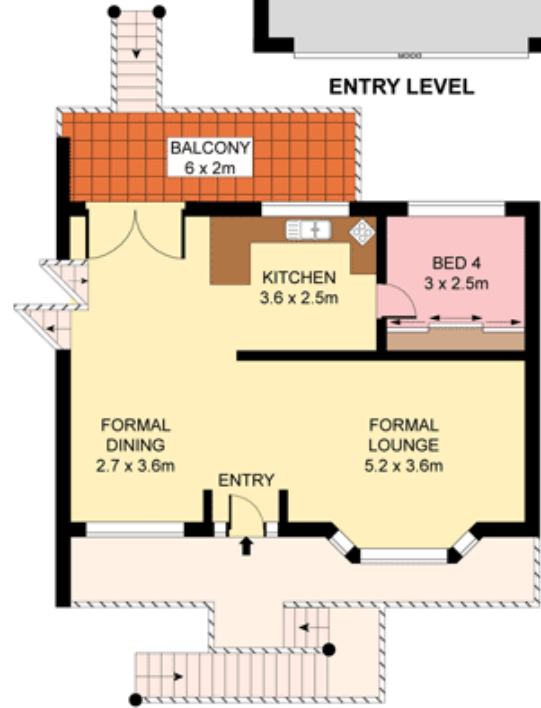

ENTRY LEVEL

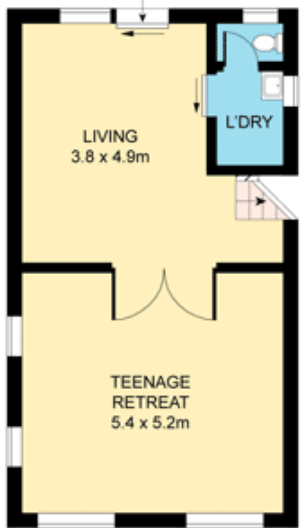

LOWER LEVEL

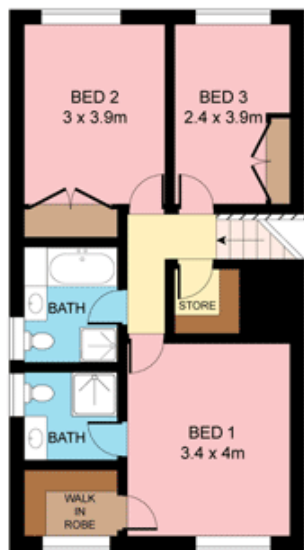

UPPER LEVEL

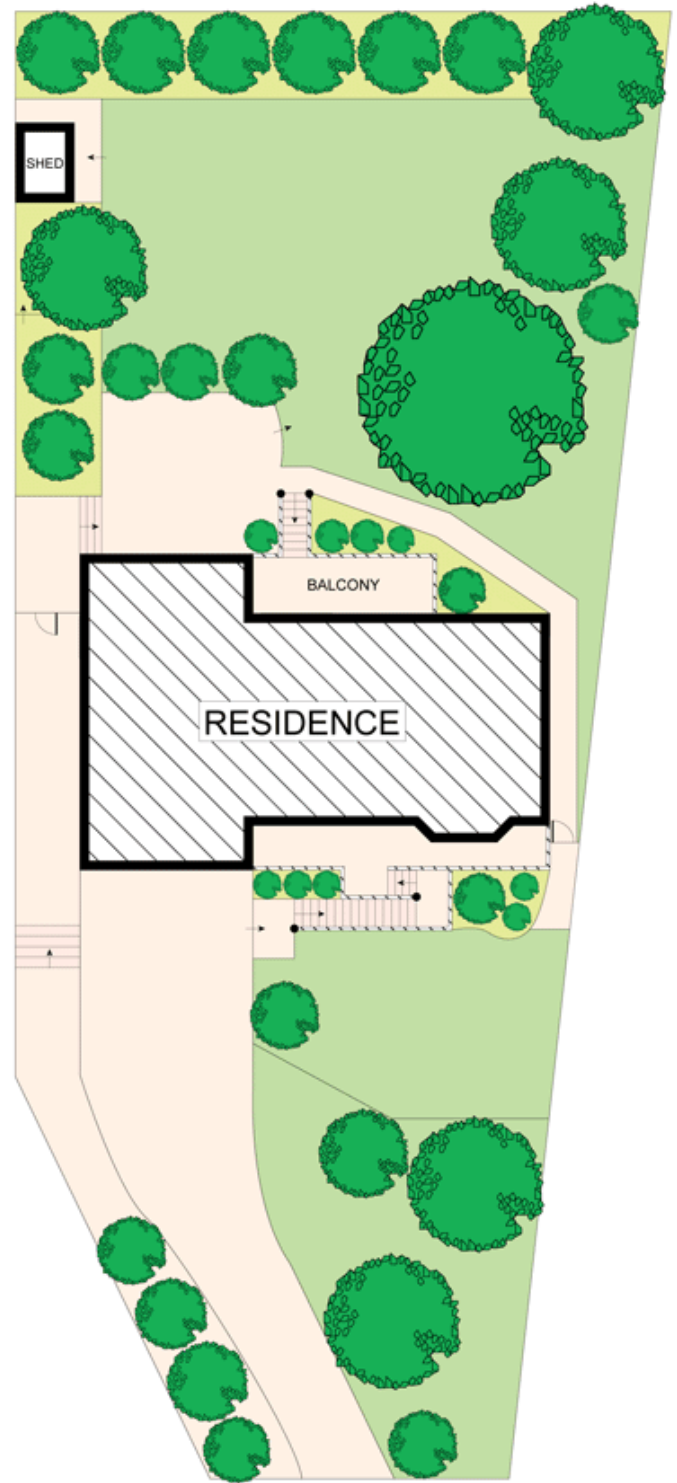

**SITE PLAN
(NOT TO SCALE)**



Plans shown are for presentation purposes only and are not part of any legal document or title. They are subject to errors, omissions, inaccuracies and should not be used as a sole and accurate reference. Interested parties should make their own inquiries using independent sources.

