



10 Swallow Rock Drive GRAYS POINT NSW

3 2 2

Overlooking the unique landscape of Swallow Rock Reserve, this well presented home displays a spacious two level design with sprawling living areas and multiple decks capitalising on the tranquil views from almost every room. Designed for private family living a striking pool sits amongst the native foliage, aspected to enjoy the special locale.

- An easy stroll to the updated Swallow Rock boat ramp
- Two level floor plan with expansive lounge and dining
- Kitchen with breakfast bar adjoins the casual dining
- Wide verandahs on both levels, covered alfresco deck
- Three beds plus study on top level, main with ensuite
- Laundry/powder, DLUG, close to shops, school & bus

Type : House
Land Size : 744 sqm
View : <https://www.jreproperty.com.au/sale/nsw/sutherland/grays-point/residential/house/7488373>



Luke Jeffree
02 9540 2222

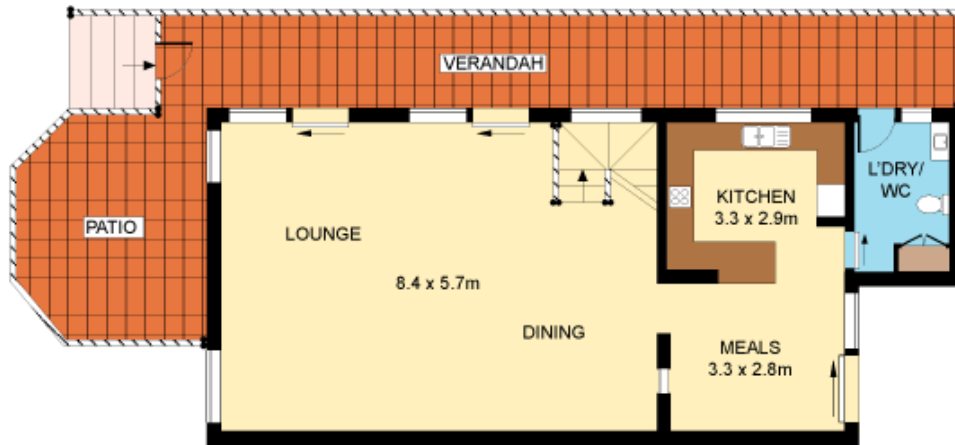

GROUND FLOOR

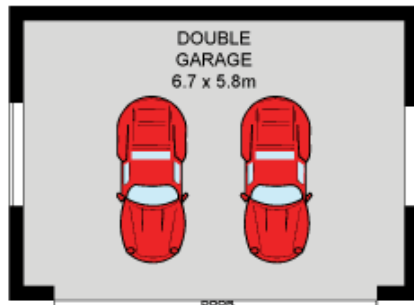

STREET LEVEL

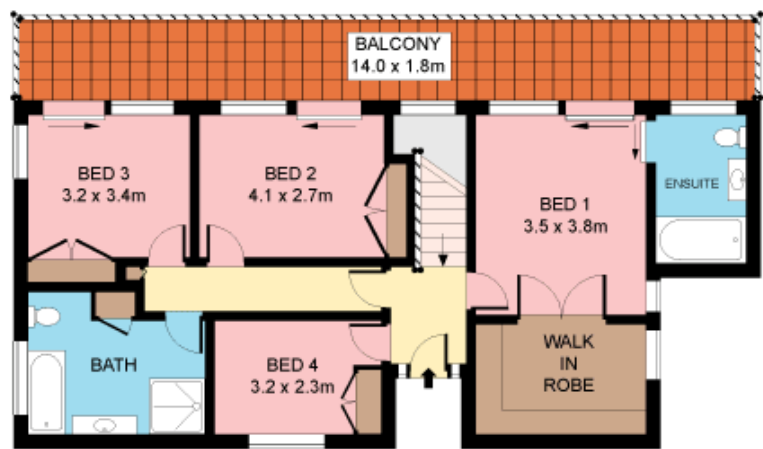

ENTRY LEVEL



SITE PLAN (NOT TO SCALE)



Plans shown are for presentation purposes only and are not part of any legal document or title. They are subject to errors, omissions, inaccuracies and should not be used as a sole and accurate reference. Interested parties should make their own inquiries using independent sources.

10 SWALLOW ROCK DRIVE

GRAYS POINT

