



55 Spur Crescent LOFTUS NSW

3 1 1

Enjoying an elevated position with an appealing leafy outlook, this dual level family home displays many special qualities. Versatile accommodation, large pool, generous lot and sought after setting in one of the areas best locations offers immense appeal as does it convenient position just metres to the bus and walking distance to schools and shops.

- Multiple living with lounge, dining & rumpus
- Front deck to enjoy the views, reverse air-con.
- Spacious alfresco terrace with b-b-que area
- Good sized beds, bathroom with spa bath
- Lower level powder room, laundry, storage
- North Facing, timber floors, SLUG, internal entry

Type : House
Price : \$ 675,000
Land Size : 562 sqm
View : <https://www.jreproperty.com.au/sale/nsw/sutherland/loftus/residential/house/7488414>



Luke Jeffree
02 9540 2222



GROUND FLOOR

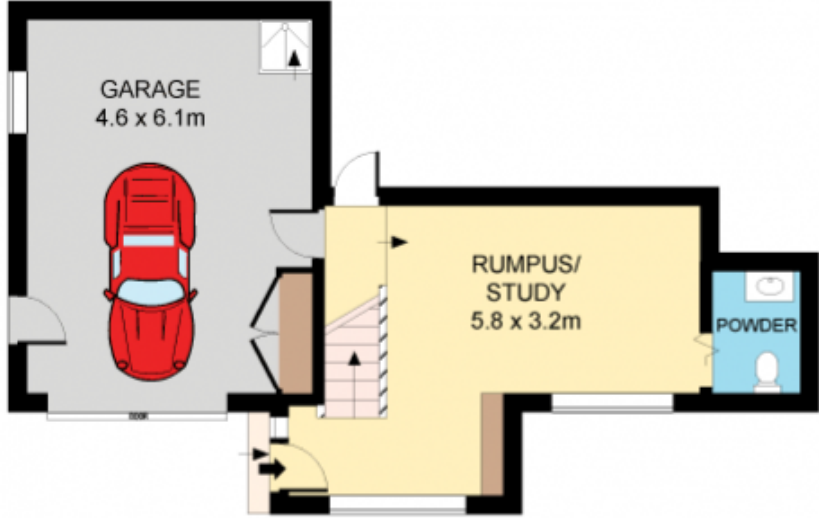

LOWER GROUND FLOOR

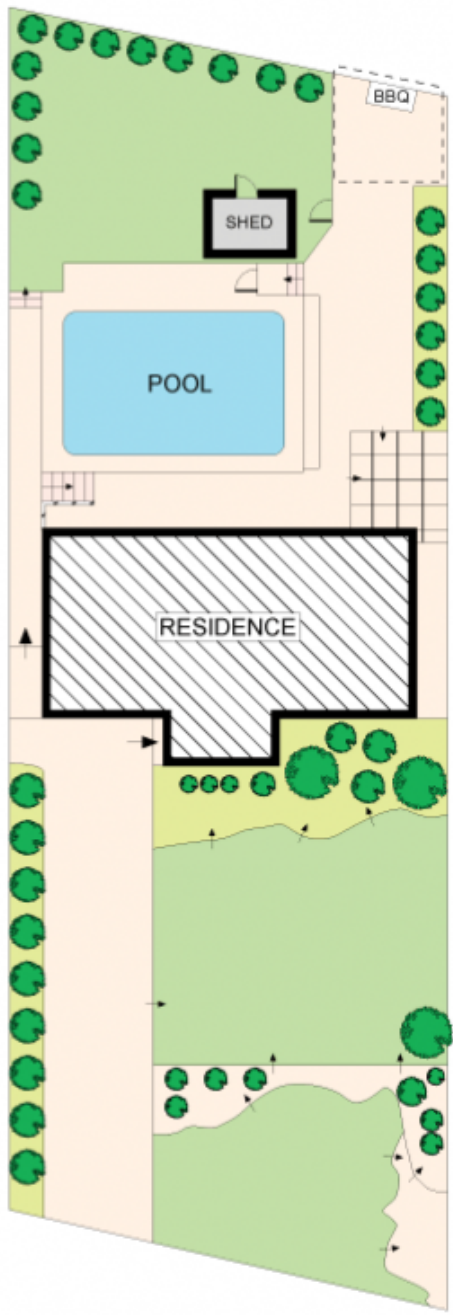

SITE PLAN (NOT TO SCALE)



Plans shown are for presentation purposes only and are not part of any legal document or title. They are subject to errors, omissions, inaccuracies and should not be used as a sole and accurate reference. Interested parties should make their own inquiries using independent sources.