



**5 Blackburn Place GYMEA NSW**

3 2 2

Situated in a quiet sought after cul-de-sac with just 12 residences, this modern home is within easy reach of everything. Its just a short 10 minute stroll to GyMEA Village, the train station, all within the Kirrawee High catchment area.

Huge 32 metre street frontage, this split level brick property features 3 double bedrooms, all with built ins. Main with ensuite and walk-in wardrobe, plus an adjacent office/nursery.

Updated main bathroom with separate vanity room. New kitchen with Bosch appliances. Internal access to tandem garage and workshop area with 8 metres of metal shelving, along with massive storage.

**Type** : House  
**Land Size** : 556 sqm  
**View** : <https://www.jreproperty.com.au/sale/nsw/sutherlandland/gyMEA/residential/house/7488416>



**Luke Jeffree**  
02 9540 2222

[For full version visit the website](https://www.jreproperty.com.au)

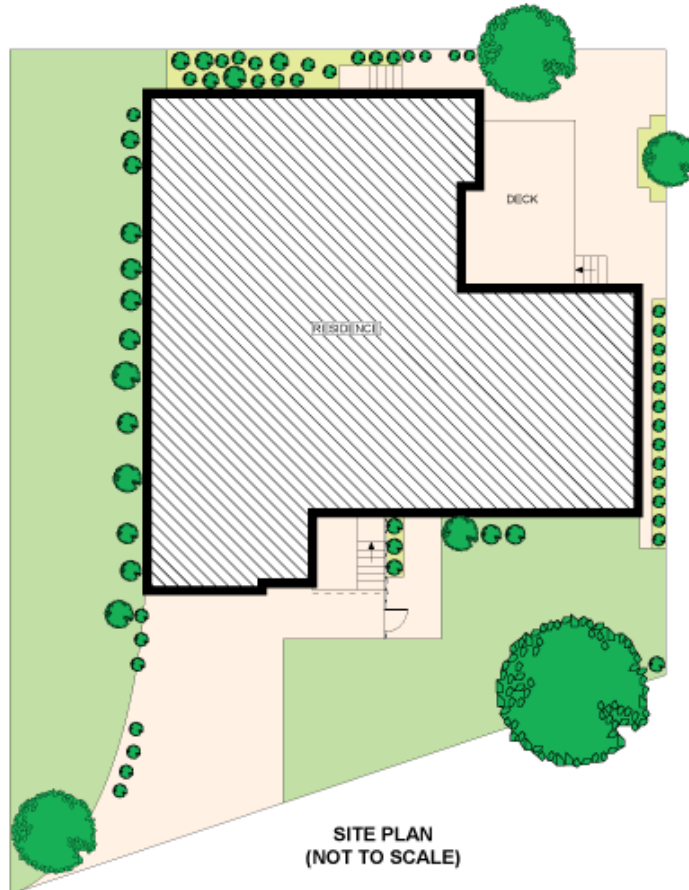

Plans shown are for presentation purposes only and are not part of any legal document or title. They are subject to errors, omissions, inaccuracies and should not be used as a sole and accurate reference. Interested parties should make their own inquiries using independent sources.

5 BLACKBURN PLACE

GYMEA BAY

