

11/10-14 Warburton Street GYMEA NSW

2 1 2

Located in a highly regarded security complex, this unique ground floor unit boasts an open plan living area adjoining the large kitchen & terrace. Positioned for a lifestyle of unbeatable convenience, its a short walk to a delightful array of village shops and cafes, rail and bus. For all buyers ensure you view this terrific unit this weekend to avoid disappointment.

- Appealing and modern well maintained security complex
- Generous living and dining expands onto garden deck
- Large entertainers kitchen with breakfast bar
- Two bedrooms, both with built in robes
- Renovated bathroom & two separate lock up garages
- Tiled floors throughout, great entry into desirable locale

Type : Unit
Land Size : 137 sqm
View : <https://www.jreproperty.com.au/sale/nsw/sutherland/gyMEA/residential/unit/7488433>



Luke Jeffree
02 9540 2222

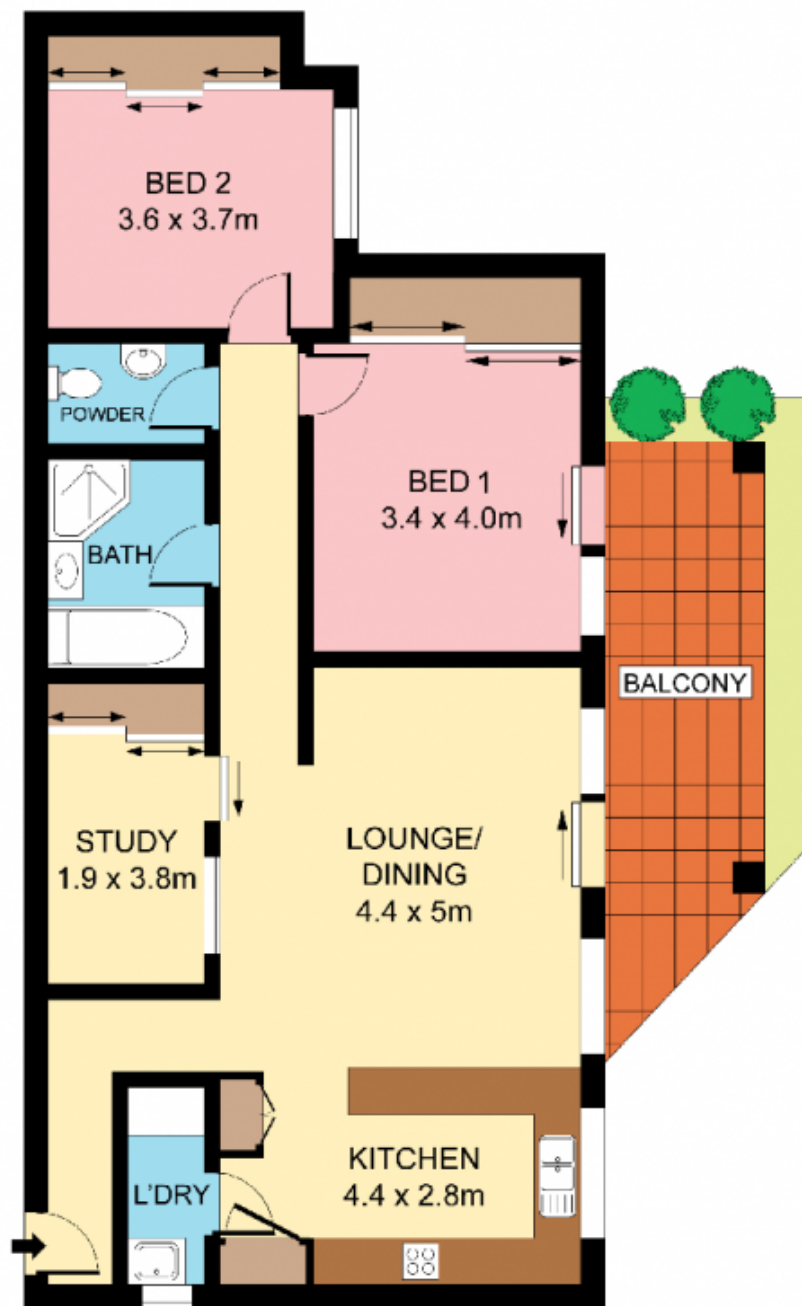

GROUND FLOOR



Plans shown are for presentation purposes only and are not part of any legal document or title. They are subject to errors, omissions, inaccuracies and should not be used as a sole and exclusive reference. Interested parties should make their own enquiries using independent sources.

11/10 WARBURTON STREET

GYMEA

