



5 Bonnie View Street GYMEA NSW

4 3 2

A stunning compilation of contemporary and country blended together into one sensational package. Boasting easy single level living designed for the entertainer, this great home has generously proportioned bedrooms plus a terrific sized home office. This great sized and level block is further benefited by the private north facing backyard and covered outdoor spa plus a shed. Secure off street parking ideal for a boat or caravan. Absolutely stunning entertainers kitchen and a designer main bathroom your friends will envy. All this is quietly positioned yet only a short walk from bustling Gymea village and train station.

Type : House
Land Size : 771 sqm
View : <https://www.jreproperty.com.au/sale/nsw/sutherlandland/gymea/residential/house/7488459>



Luke Jeffree
02 9540 2222



GROUND FLOOR

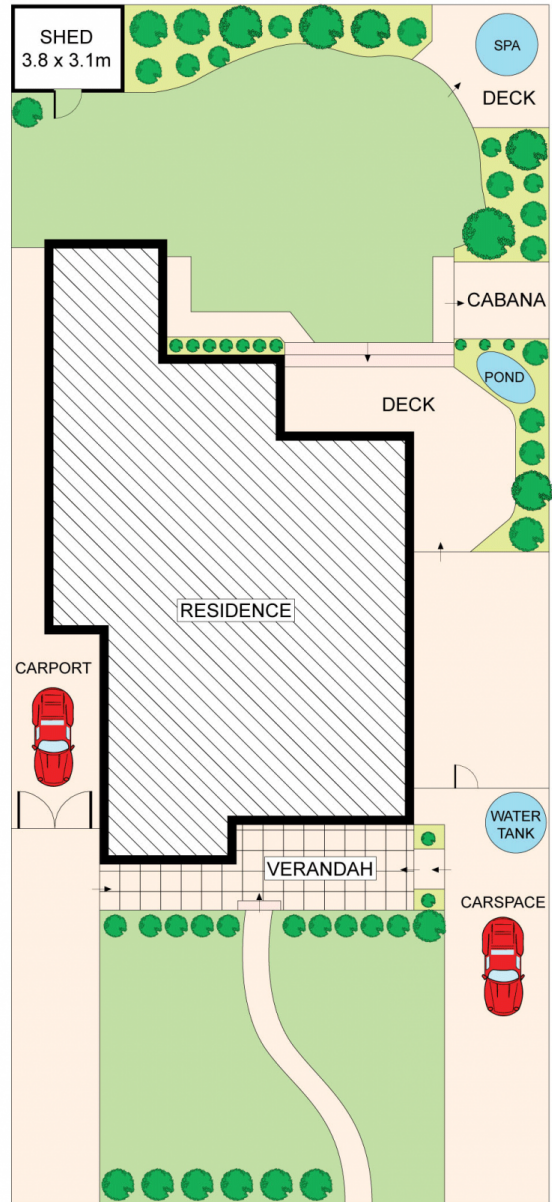

**SITE PLAN
(NOT TO SCALE)**



Plans shown are for presentation purposes only and are not part of any legal document or title. They are subject to errors, omissions, inaccuracies and should not be used as a sole and accurate reference. Interested parties should make their own inquiries using independent sources.

5 BONNIE VIEW STREET

GYMEA