



111 Talara Road GYMEA NSW

4 2

This humble cottage scores high on location, enjoying a peaceful setting just moments to the village, bus, rail and schools. Very original throughout, its dual level floor plan easily accommodates the family and offers potential for the astute home owner or renovator. Explore the many options on offer.

Land Size : 581.7 sqm
View : <https://www.jreproperty.com.au/sale/nsw/sutherland/gyMEA/residential/house/7488547>

Dual level design, leafy district outlook
Large modern kitchen with breakfast bar
Dining adjoins the kitchen, casual living
Study nook, master retreat with ensuite
Level and secure rear yard and terrace
Garden shed, Kirrawee high catchment



Dion Moon
02 9540 2222

*Council Rates - \$429.00 per quarter
*Water Rates - \$148.10 per quarter



LOWER GROUND FLOOR

GROUND FLOOR

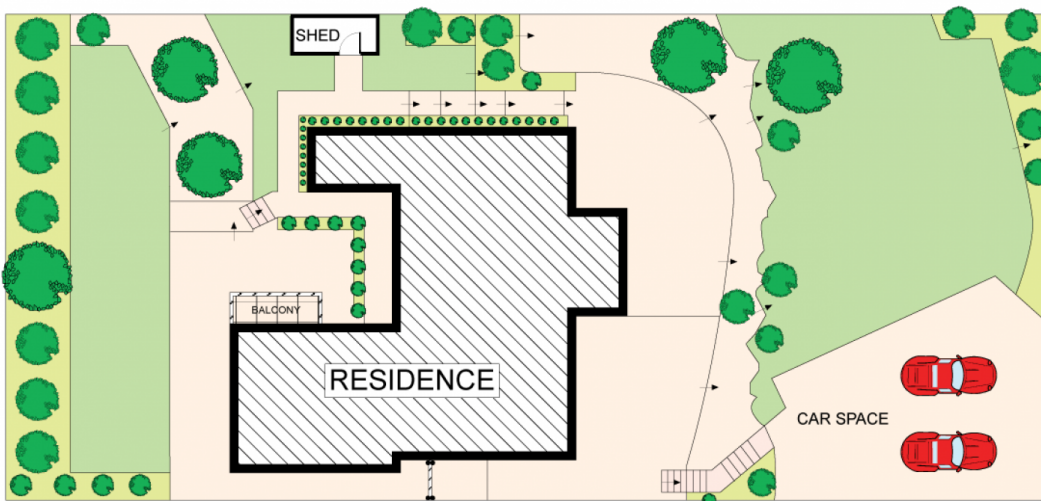

SITE PLAN (NOT TO SCALE)



Plans shown are for presentation purposes only and are not part of any legal document or title. They are subject to errors, omissions, inaccuracies and should not be used as a sole and accurate reference. Interested parties should make their own inquiries using independent sources.