



**51 Coonong Road GYMEA BAY NSW**

4 3 3

This absolutely spotless home represents an exciting opportunity located in a whisper quite and picturesque family friendly pocket. Held for over 40 years, it rests on a superb 999 sqm block with pool and is a tradies paradise with its multiple sheds and structures offering a wealth of possibilities. Its just a short stroll to Gymea Bay Public and within Kirrawee High catchment area.

**Land Size** : 999 sqm  
**View** : <https://www.jreproperty.com.au/sale/nsw/sutherland/gymea-bay/residential/house/7488549>

- Spacious easy living single level plan
- Generous open plan living with fire
- Original kitchen with adjoining dining
- Family room, front and back terraces
- Triple lock up garage, workshed, a/c
- Separate self contained accommodation



**Luke Jeffree**  
02 9540 2222

\*Water Rates - \$286.00 per quarter  
\*Council Rates - \$492.70 per quarter



GROUND FLOOR

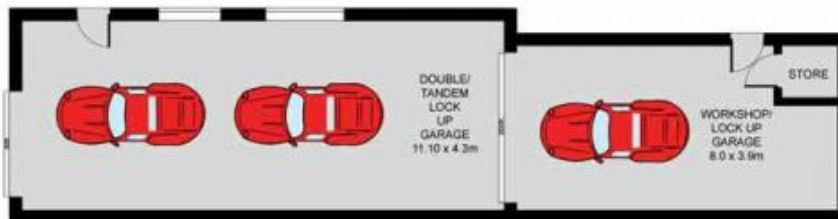
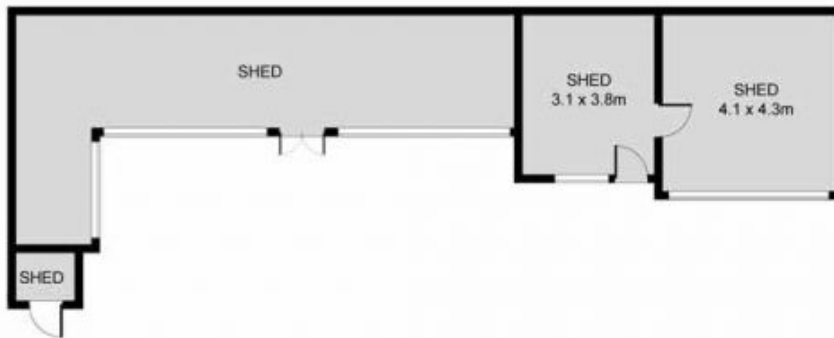

SITE PLAN (NOT TO SCALE)



Plans shown are for presentation purposes only and are not part of any legal document or title. They are subject to errors, omissions, inaccuracies and should not be used as a sole and accurate reference. Interested parties should make their own inquiries using independent sources.

