



15 Nyinya Avenue GYMEA NSW

3 1 2

This wonderful opportunity presents itself for young families, first home buyers or investors to purchase this affordable home on a corner block situated within walking distance to Gymea boutique shops, cafes and transport. Feel like you are on holidays every day, with a large north facing deck, perfect for entertaining including a Jacuzzi and versatile multi-purpose room perfect for the growing family. (17.3/19.8+33/25.6= 607sqm)

Land Size : 607 sqm
View : <https://www.jreproperty.com.au/sale/nsw/sutherland/gymea/residential/house/7488587>

- 3 light filled bedrooms all with BIR
- Renovated kitchen with stone benchtops
- Main bathroom with corner spa bath
- Fully fenced, grassed yards & jacuzzi
- Internal laundry with 2nd w.c/plenty of storage
- 3 x split system air con/ polished floor boards



Luke Jeffree
02 9540 2222

SITE PLAN (not to scale)

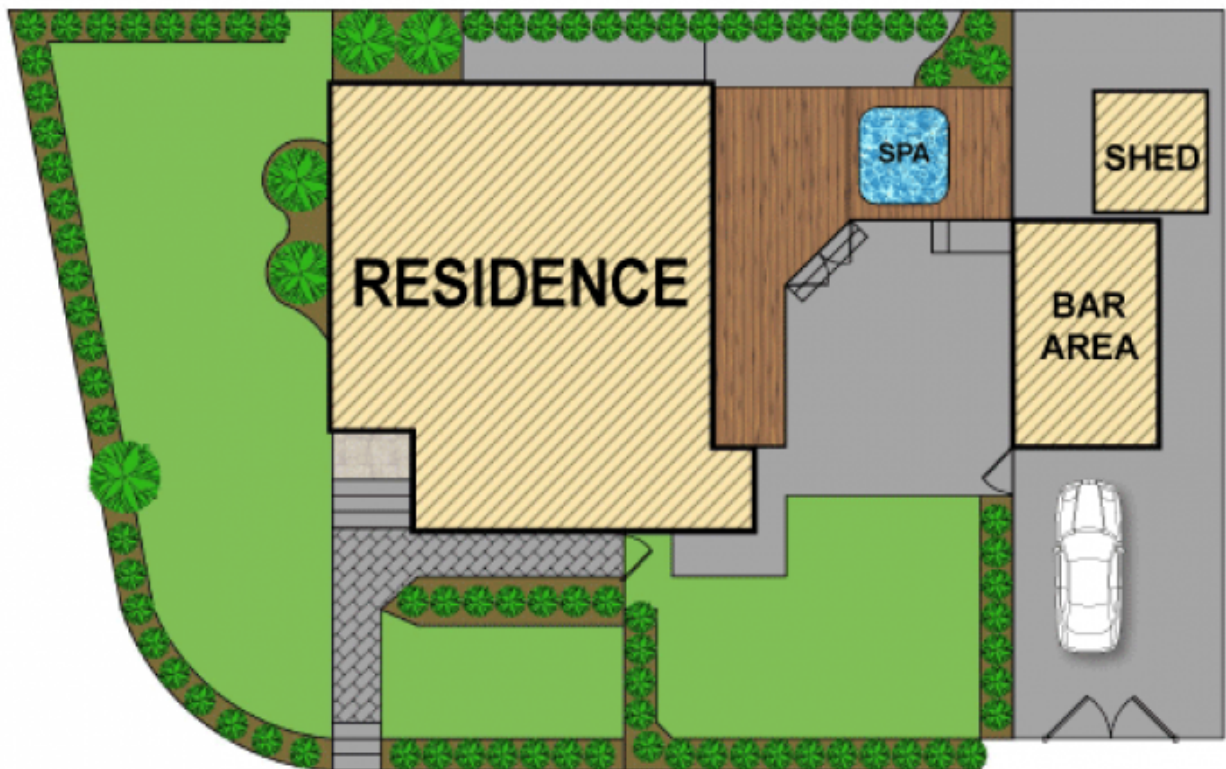

ADDRESS:

15 Nyinya Avenue, GYMEA

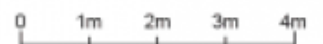

DISCLAIMER: THIS IS FOR ILLUSTRATIVE PURPOSES ONLY. ALL DIMENSIONS ARE APPROXIMATE AND IT DOES NOT CONSTITUTE PART OF ANY LEGAL DOCUMENTS.