



5/649-653 Kingsway GYMEA NSW

2 2 1

Set well apart from its peers, this fresh and contemporary residence provides a spectacular easy care environment offering wide appeal for executives, downsizers and families. This 2 bedroom townhouse is substantial throughout with its light filled and free flowing interiors showcasing a spacious lounge, renovated kitchen and bathrooms and a sunny fully landscaped north facing courtyard. Promising a lifestyle of premium comfort, the townhouse is set at the back of this stylish complex and delivers a cosmopolitan lifestyle with a short stroll to Gymea train station, schools and cafes.

Type : Townhouse
Land Size : 175 sqm
View : <https://www.jreproperty.com.au/sale/nsw/sutherland/gymea/residential/townhouse/7488600>



Luke Jeffree
02 9540 2222

Open plan living/ducted reverse cycle air throughout
Caesarstone kitchen with gas cooktop/heating
Large bedrooms with BIRs, main with ensuite

[For full version visit the website](https://www.jreproperty.com.au)



SITE PLAN (not to scale)



UPPER FLOOR

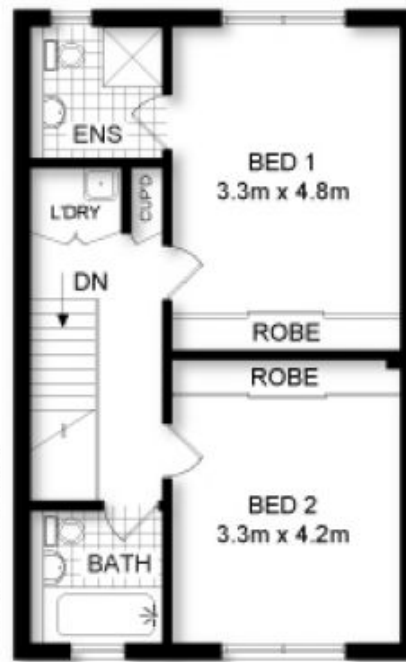

GROUND FLOOR

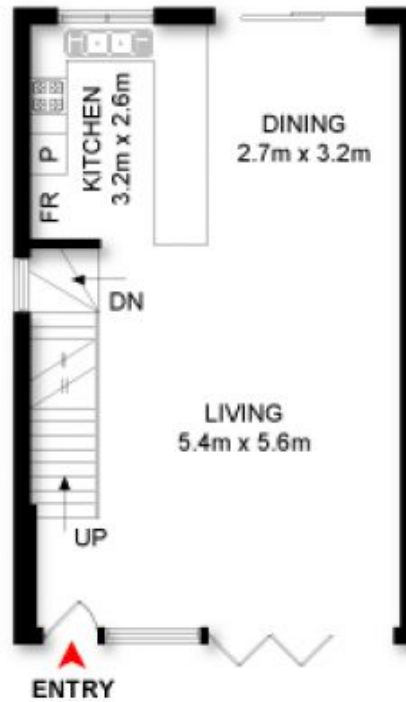

LOWER FLOOR

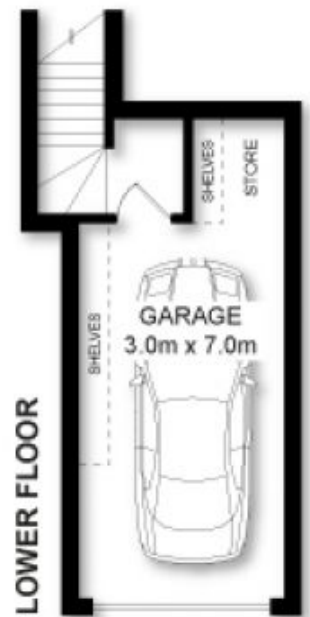

ADDRESS:

5/649 Kingway, GYMEA



DISCLAIMER: THIS IS FOR ILLUSTRATIVE PURPOSES ONLY. ALL DIMENSIONS ARE APPROXIMATE AND IT DOES NOT CONSTITUTE PART OF ANY LEGAL DOCUMENTS.