



10 Flat Rock Road GYMEA BAY NSW

4 2 2

Occupying a private setting with picturesque views over the Port Hacking, this family home provides a generous floor plan with multiple indoor and outdoor entertaining options for a growing family.

On entry you are immediately introduced to the light filled interconnecting living spaces with a peaceful leafy outlook and a timber deck wrapping the open plan living enjoying Bay views.

Downstairs provides spacious bedrooms including a master complete with ensuite, a large rumpus room with adjoining outdoor timber decking area, fourth bedroom/ study and main family bathroom.

The rear yard provides the perfect playground for the

[For full version visit the website](#)

Type : House
Land Size : 708.2 sqm
View : <https://www.jreproperty.com.au/sale/nsw/sutherlandland/gymea-bay/residential/house/7488900>



Luke Jeffree
02 9540 2222

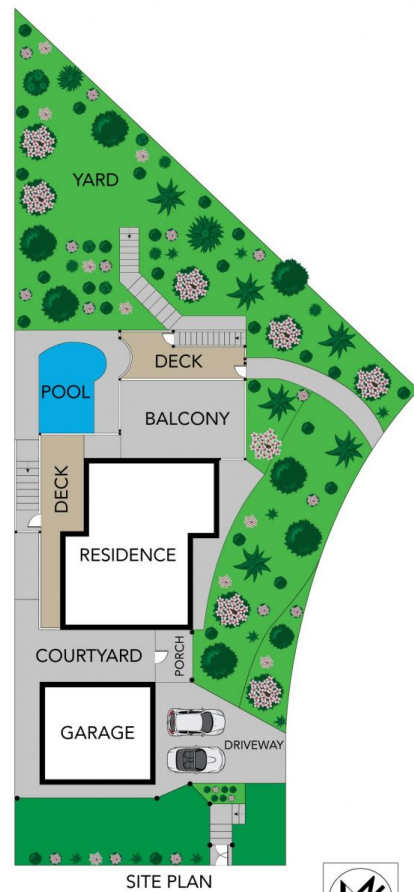

Scale in metres. Indicative only. Dimensions are approximate. All information contained herein is gathered from sources we believe to be reliable. However, we cannot guarantee its accuracy and interested persons should rely on their own enquiries.

