



11 Huskisson Street GYMEA BAY NSW

5 3 2

A restful setting enjoying lush leafy surrounds and tranquil running water this family home presents an idyllic lifestyle with peace and privacy.

Perfectly designed for a growing family and providing a versatile design, this dual level home also offers the unique opportunity to work from home with a separate entry on ground level.

An entertainers' retreat enjoying a premium setting embracing the beauty of its bushland setting and ensures premium easy-care living.

- Spacious open plan living, kitchen and dining with private leafy aspect

[For full version visit the website](https://www.jreproperty.com.au)

Type : House
Land Size : 575.4 sqm
View : <https://www.jreproperty.com.au/sale/nsw/sutherland/gymea-bay/residential/house/7488914>



Luke Jeffree
02 9540 2222

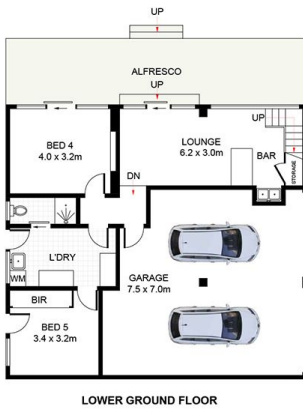

11 Huskisson Street, Gymea Bay

DISCLAIMER: PLANS SHOWN ARE FOR PRESENTATION PURPOSES AND ARE NOT PART OF ANY LEGAL DOCUMENT. ALL MEASUREMENTS AND FIGURES ARE APPROXIMATE.