



**30 Valley Way GYMEA BAY NSW**

4 2 2

A remarkable multi-level residence embracing the beauty of its bushland elevated setting and nested amongst the trees this double brick home is generously proportioned and provides a family versatile design. Enjoying a premium setting at the end of a quiet cul-de-sac street, with a north facing back yard and large decks, this home will be perfectly suited to a broad target audience including extended families looking for more separate spaces.

- \* Four bedrooms with wardrobes and private balcony's + study
- \* Master bedroom with ensuite & walk in wardrobe
- \* Multiple separate living & dining areas which flows to outdoor entertaining
- \* Low maintenance serene backyard / undercover

**Type** : House  
**Land Size** : 729.1 sqm  
**View** : <https://www.jreproperty.com.au/sale/nsw/sutherlandland/gymea-bay/residential/house/7488927>



**Luke Jeffree**  
02 9540 2222

[For full version visit the website](https://www.jreproperty.com.au)



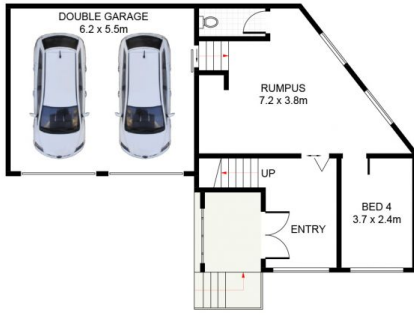

GROUND FLOOR



FIRST FLOOR

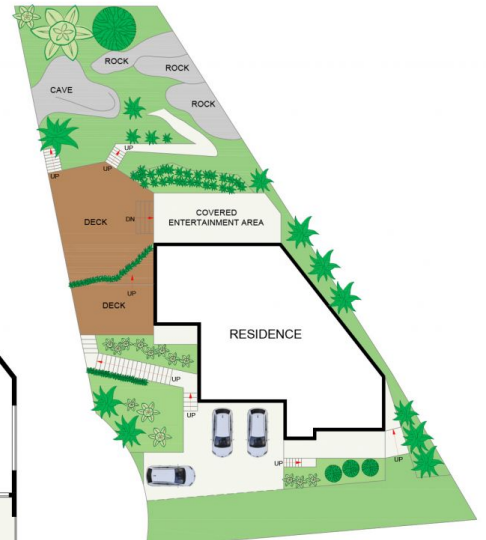

SITE PLAN  
(NOT TO SCALE)



## Valley Way, Gymea Bay

DISCLAIMER: PLANS SHOWN ARE FOR PRESENTATION PURPOSES AND ARE NOT PART OF ANY LEGAL DOCUMENT. ALL MEASUREMENTS AND FIGURES ARE APPROXIMATE.