



18 Opal Place GYMEA NSW

3 1 2

Presenting an entry point into a desirable suburb, this brick home with cottage appeal offers a great start to first home buyers and plenty of potential with further scope to extend resting on a 562.8 sqm level block.

- * Fully fenced grassed yard, double carport
- * Corner position, ample off-street parking
- * Lounge and dining with timber flooring
- * 3 bedrooms built-in robes in 2 rooms
- * Functional kitchen with large gas stove
- * Sun-drenched northerly aspect
- * Currently leased until 20/2/2020 for \$625pw

Type : House
Land Size : 562.8 sqm
View : <https://www.jreproperty.com.au/sale/nsw/sutherland/gymea/residential/house/7488931>



Luke Jeffree
02 9540 2222

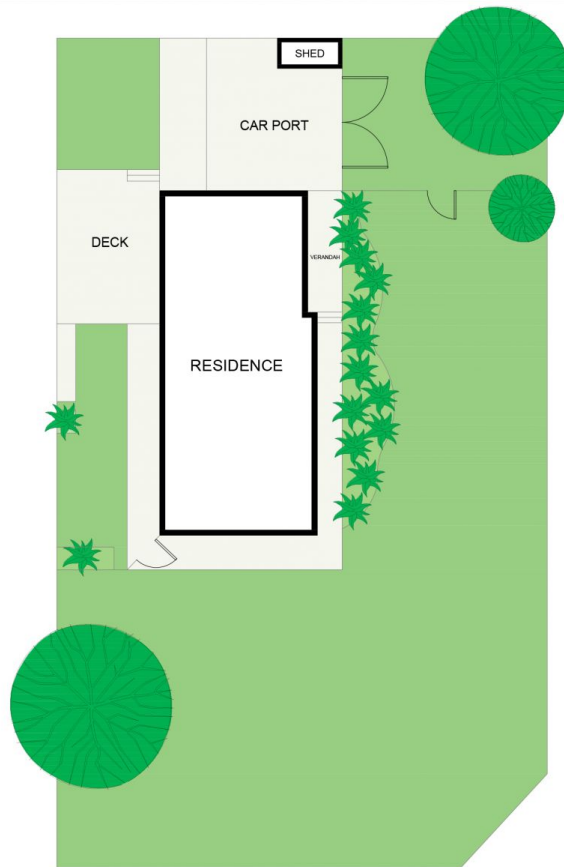

SITE PLAN
(NOT TO SCALE)



18 Opal Place, GyMEA

DISCLAIMER: PLANS SHOWN ARE FOR PRESENTATION PURPOSES AND ARE NOT PART OF ANY LEGAL DOCUMENT. ALL MEASUREMENTS AND FIGURES ARE APPROXIMATE.