



11 Kemp Avenue KIRRAWEE NSW

3 **2** **1**

IMMACULATE FAMILY RESIDENCE

Truly a home of rare charm and appeal while perfectly positioned in a highly sought after tree-lined street, this family brick home is reluctantly offered for sale. Sitting proudly on a sun-drenched level landscaped block this is a rare opportunity to secure a dream home in this tightly held area.

Internal features include, spacious kitchen with adjoining dining area, a large elevated living area that leads to a covered alfresco with a separate rumpus/games room below.

Enjoy time outdoors in the sunny rear yard with an above

Type : House
Land Size : 556 sqm
View : <https://www.jreproperty.com.au/sale/nsw/sutherlandland/kirrawee/residential/house/7488939>

[For full version visit the website](https://www.jreproperty.com.au)

<https://www.jreproperty.com.au>

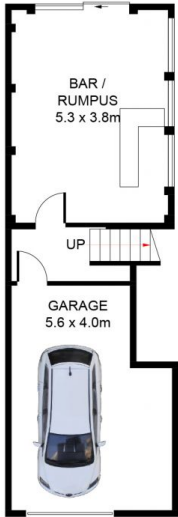

LOWER GROUND FLOOR

EXISTING FOUNDATION AREA
(SUB FLOOR)



GROUND FLOOR

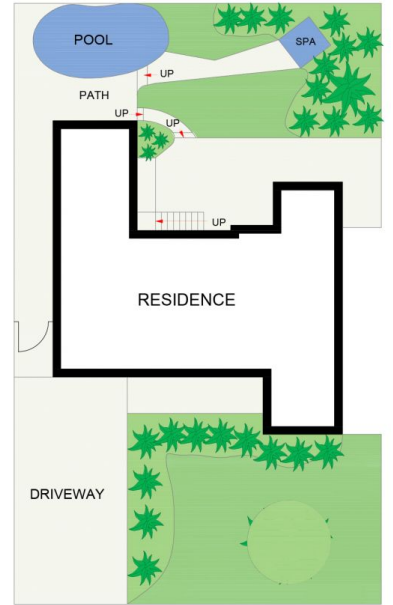

SITE PLAN
(NOT TO SCALE)



Kemp Street, Kirrawee

DISCLAIMER: PLANS SHOWN ARE FOR PRESENTATION PURPOSES AND ARE NOT PART OF ANY LEGAL DOCUMENT. ALL MEASUREMENTS AND FIGURES ARE APPROXIMATE.