



1/9 Premier Street GYMEA NSW

3 2 1

Perfectly positioned at the back of this boutique complex of only 3, you will just love the space and convenience this townhouse has to offer. With no common walls, light filled interiors and plenty of privacy this home is ready for immediate enjoyment.

- * Separate plan lounge & dining room / ducted air conditioning
- * Galley style kitchen with breakfast bar and gas cooking
- * 3 Very generous bedrooms, all with built in wardrobes and ceiling fans
- * North facing paved outdoor alfresco terrace with established gardens
- * Single lock up garage with internal access
- * Strata \$788.50 p/q | Council \$354 p/q

[For full version visit the website](https://www.jreproperty.com.au)

Type : Townhouse
Land Size : 185 sqm
View : <https://www.jreproperty.com.au/sale/nsw/sutherland/gyMEA/residential/townhouse/7488947>



Luke Jeffree
02 9540 2222

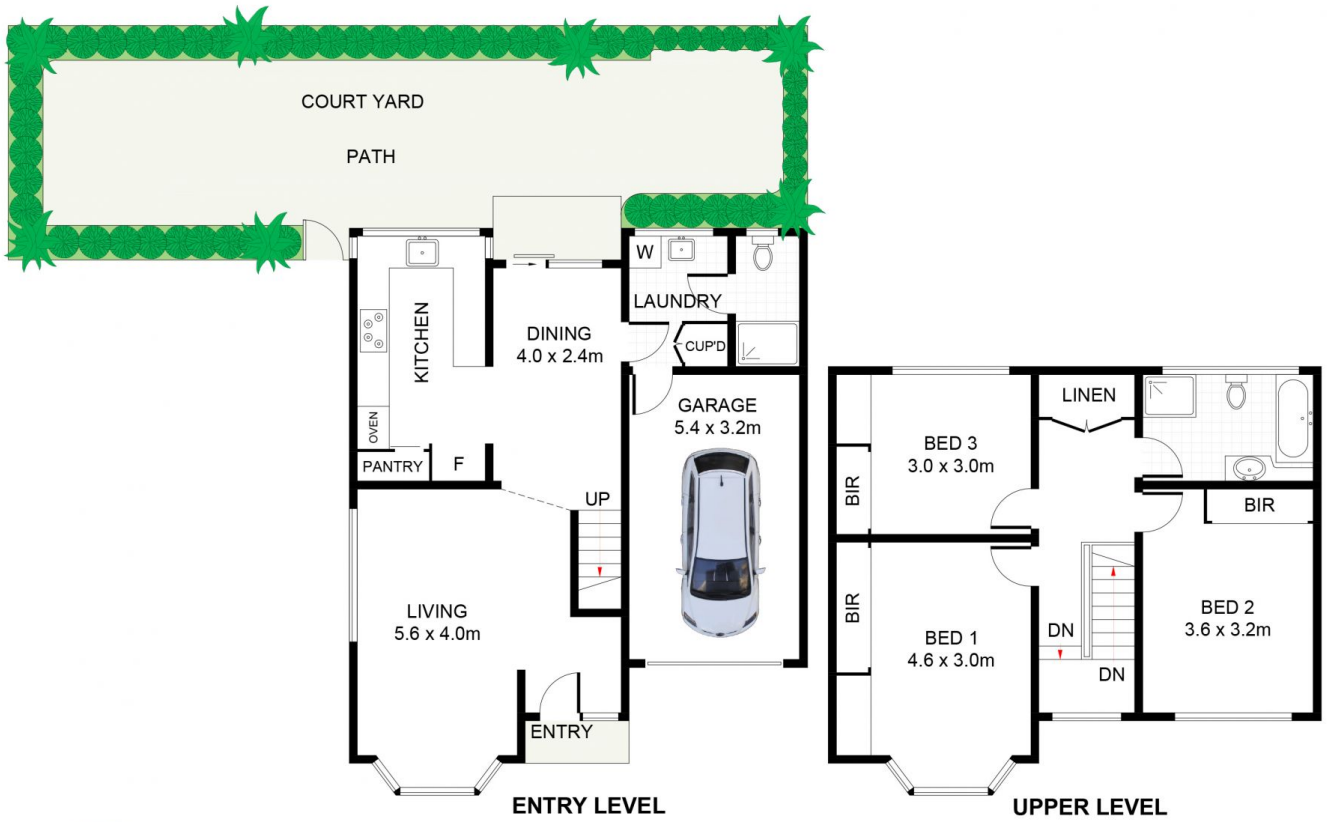

Premier Street, Gymea

DISCLAIMER: PLANS SHOWN ARE FOR PRESENTATION PURPOSES AND ARE NOT PART OF ANY LEGAL DOCUMENT. ALL MEASUREMENTS AND FIGURES ARE APPROXIMATE.