



1 Meehan Place KIRRAWEE NSW

5 3 3

Occupying a desirable elevated position on the high side of the street and enjoying a tranquil leafy outlook over the Royal National Park proudly sits this master built full brick residence. An impressively designed and presented home with an expansive floorplan caters to both family living and entertaining whilst offering an idyllic lifestyle of peace and privacy.

Type : House
Land Size : 556.4 sqm
View : <https://www.jreproperty.com.au/sale/nsw/sutherlandland/kirrawee/residential/house/7488952>

- * 5 generous size bedrooms with built in wardrobes, master with ensuite
- * A multitude of living areas, with additional study / office
- * Impressive entertainers kitchen with stunning natural stone benchtops
- * Polished timber flooring / ducted air conditioning
- * Large rumpus area with wet bar/ cellar and abundance of

[For full version visit the website](#)

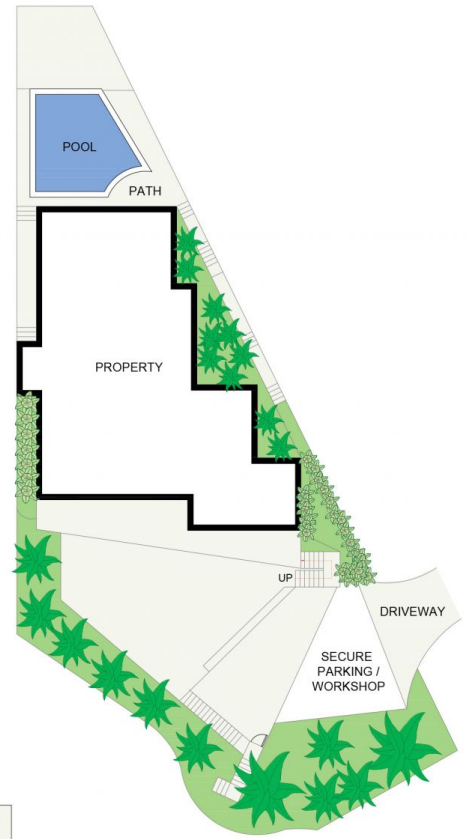
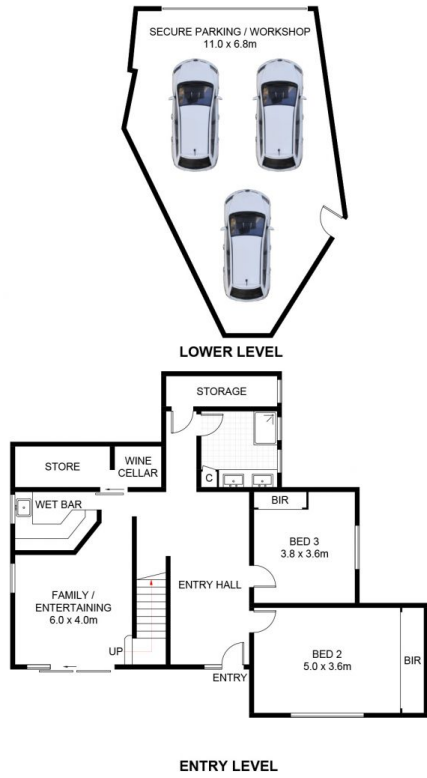

SITE PLAN
(NOT TO SCALE)



Meehan Place, Kirrawee

DISCLAIMER: PLANS SHOWN ARE FOR PRESENTATION PURPOSES AND ARE NOT PART OF ANY LEGAL DOCUMENT. ALL MEASUREMENTS AND FIGURES ARE APPROXIMATE.