



10 Coopernook Avenue GYMEA BAY NSW

3 2 1

Occupying a premium 752sqm, sunny block in a quality street, this original home offers exceptional buying into a sought after locale. Displaying a versatile single level floor plan surrounded by generous flat lawns and an inground pool over looking the glistening waters of GyMEA Bay. Boasting outstanding potential this home is well placed close to shops, schools and rail.

- * Multiple spacious living areas with A/C
- * Central kitchen with plenty of cupboards
- * Good sized bedrooms, one bed with robes
- * Master bedroom with ensuite + study
- * Large undercover timber deck with water views
- * Single carport, secure level grassed yard

Type : House
Land Size : 752.5 sqm
View : <https://www.jreproperty.com.au/sale/nsw/sutherland/gyMEA-bay/residential/house/7488957>



Luke Jeffree
02 9540 2222

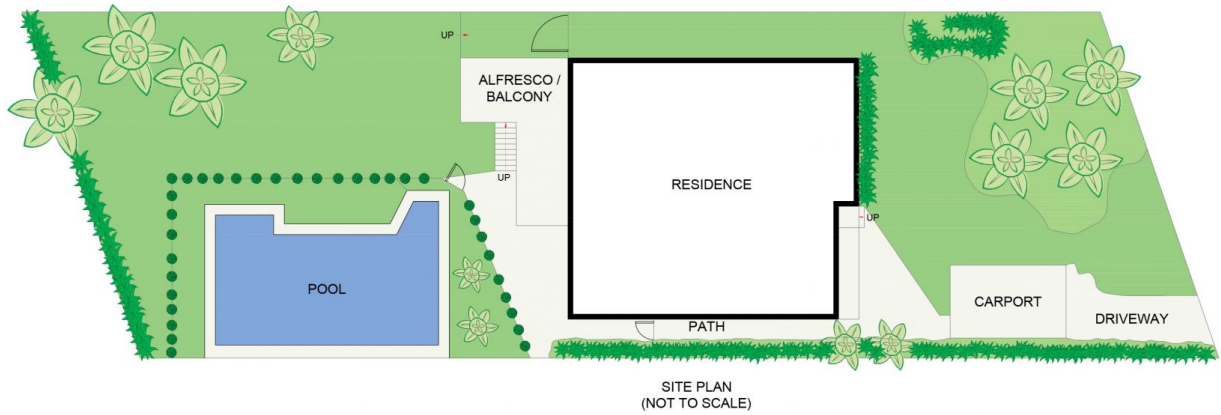

Coopernook Avenue, Gymea Bay

DISCLAIMER: PLANS SHOWN ARE FOR PRESENTATION PURPOSES AND ARE NOT PART OF ANY LEGAL DOCUMENT. ALL MEASUREMENTS AND FIGURES ARE APPROXIMATE.