



35 Naranganah Avenue GYMEA BAY NSW

4 2 2

Proudly positioned with a peaceful and private outlook this immaculate residence boasts encapsulating water views with its elevated setting.

Spaciously set over two generous levels of living and providing formal and informal living spaces this stunning residence is well proportioned throughout and ensures excellent family separation with versatile spaces catering to a variety of needs.

Entertaining will be an absolute pleasure with a quality designer kitchen that seamlessly adjoins the outdoor alfresco area complete with a bar that overlooks the inground pool and spa and surrounded by manicured low maintenance gardens.

[For full version visit the website](https://www.jreproperty.com.au)

Type : House
Land Size : 635.3 sqm
View : <https://www.jreproperty.com.au/sale/nsw/sutherland/gymea-bay/residential/house/7488990>



Luke Jeffree
02 9540 2222

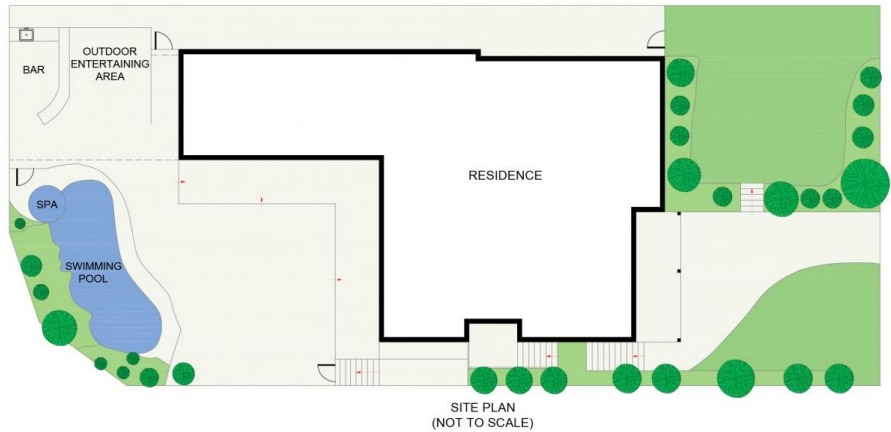

35 Naranganah Avenue, Gympie Bay

DISCLAIMER: PLANS SHOWN ARE FOR PRESENTATION PURPOSES AND ARE NOT PART OF ANY LEGAL DOCUMENT. ALL MEASUREMENTS AND FIGURES ARE APPROXIMATE.