



**19 Nulgarra Avenue GYMEA BAY NSW**

3 1 1

Peacefully set within a family friendly neighbourhood this single level family home enjoys an elevated setting and provides the opportunity to extend, renovate and add value.

The floor plan consists of a spacious kitchen with ample storage and adjoining living and dining area that leads to a balcony at that front via glass sliding doors and an additional covered entertaining area at the rear of the property.

This family home is set on 581.7sqm parcel of land in the Kirrawee High School catchment and is an ideal opportunity for buyers looking to secure their home in a well sought after location.

**Type** : House  
**Land Size** : 581.7 sqm  
**View** : <https://www.jreproperty.com.au/sale/nsw/sutherlandland/gymea-bay/residential/house/7489003>



**Luke Jeffree**  
02 9540 2222

[For full version visit the website](https://www.jreproperty.com.au)

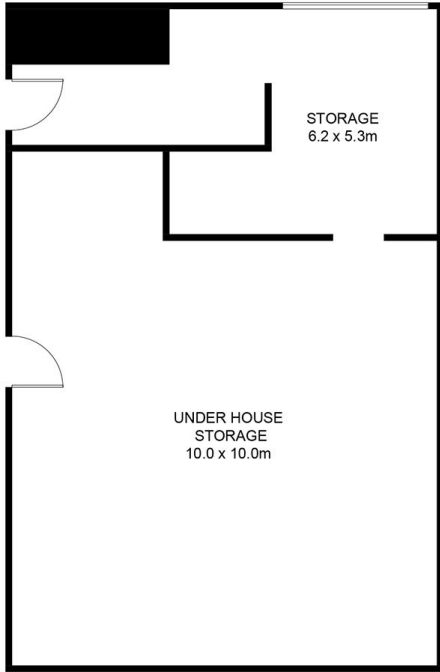

(NOT SHOWN IN ACTUAL LOCATION / ORIENTATION)

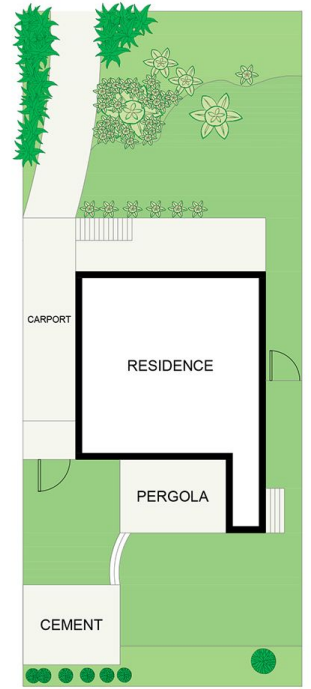

SITE PLAN  
(NOT TO SCALE)



## Nulgarra Avenue, Gymea Bay

DISCLAIMER: PLANS SHOWN ARE FOR PRESENTATION PURPOSES AND ARE NOT PART OF ANY LEGAL DOCUMENT. ALL MEASUREMENTS AND FIGURES ARE APPROXIMATE.