



34 Johnston Avenue KIRRAWEE NSW

4 1 2

Offering spacious light filled living areas throughout this north facing single level home provides a versatile floorplan with multiple living areas that flow to the outdoor entertaining and sunny level lawn with established gardens. Recently renovated and ready to move in and enjoy a fresh bright and modern interior while providing future potential to add value. Set on 556.4sqm parcel of land and is an ideal opportunity for first home buyers looking to secure a home in a quiet sought-after location and within Kirrawee High School catchment.

- Spacious light filled open plan living with adjoining dining/additional living area
- Eat-in kitchen overlooking the rear garden with adjacent dining area

Type : House
Land Size : 556.4 sqm
View : <https://www.jreproperty.com.au/sale/nsw/sutherlandland/kirrawee/residential/house/7489005>



Trent Jeffree
02 9540 2222

[For full version visit the website](https://www.jreproperty.com.au)

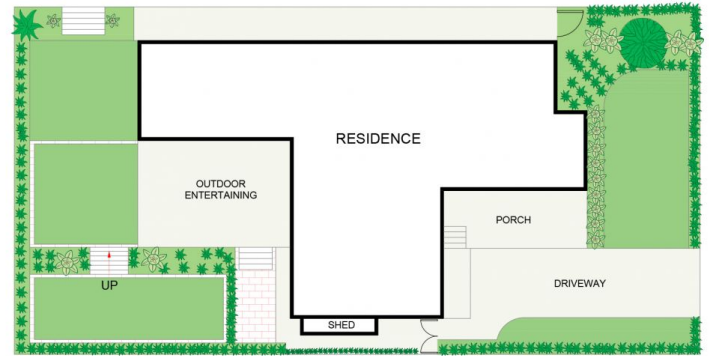

Johnston Avenue, Kirrawee

DISCLAIMER: PLANS SHOWN ARE FOR PRESENTATION PURPOSES AND ARE NOT PART OF ANY LEGAL DOCUMENT. ALL MEASUREMENTS AND FIGURES ARE APPROXIMATE.