



**4 High Street GYMEA NSW**

4 1 2

Situated on a quiet street, merely moments from reputable schools, Gymea Village and the heritage-listed Gymea Bay Baths, opportunity awaits with this 4 bedroom character weatherboard home.

The home reveals a flexible floorplan with high ceilings, ornate cornices, period sash windows and provides an opportunity to expand and enhance on the property.

The main bedroom, with its northerly aspect, is sizeable and has built in robes. Three further bedrooms define the property's family appeal with the bonus of the fourth bedroom being a clever addition that has the flexibility for a home office or private study space.

**Type** : House  
**Land Size** : 935.8 sqm  
**View** : <https://www.jreproperty.com.au/sale/nsw/sutherland/gymea/residential/house/7489047>



**Luke Jeffree**  
02 9540 2222

[For full version visit the website](https://www.jreproperty.com.au)

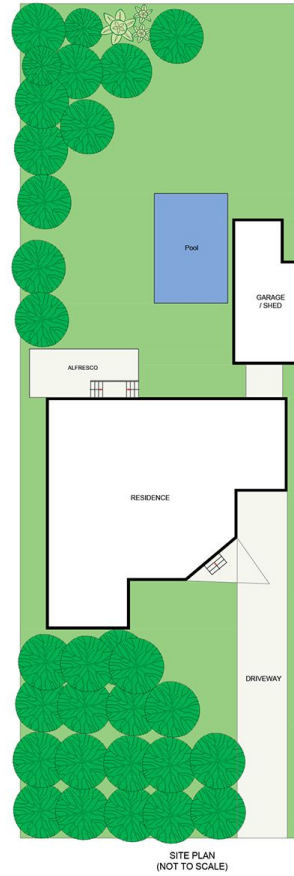
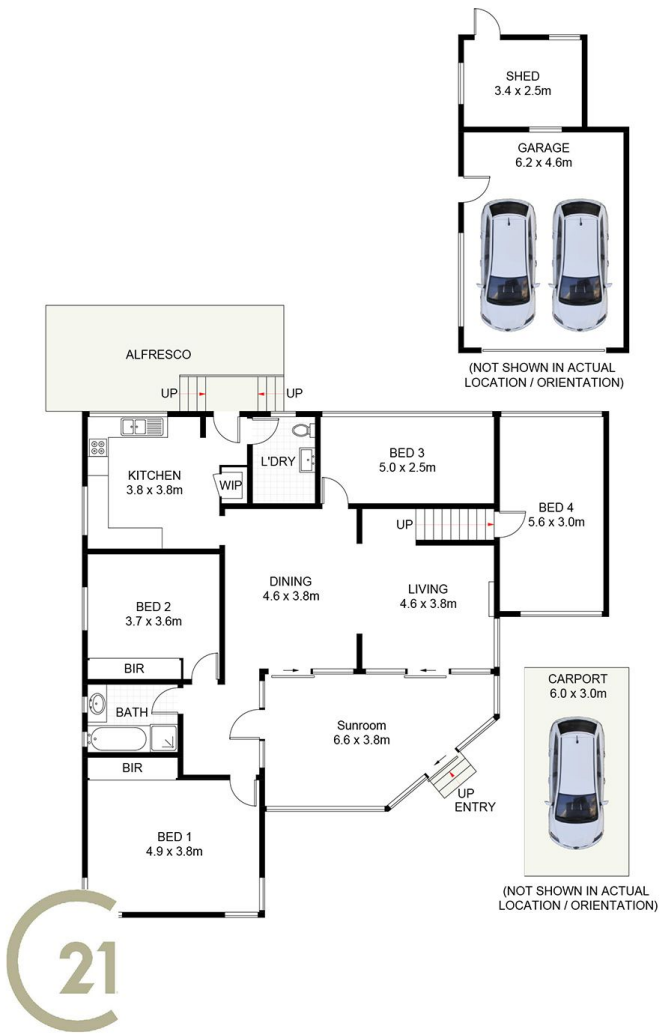

21

## 4 High Street, Gymea

DISCLAIMER: PLANS SHOWN ARE FOR PRESENTATION PURPOSES AND ARE NOT PART OF ANY LEGAL DOCUMENT. ALL MEASUREMENTS AND FIGURES ARE APPROXIMATE.