



10 Bounty Avenue KIRRAWEE NSW

4 2 3

This home is a one-of-a-kind property which is rich in character, suiting a broad demographic of buyers. Suitable for first home buyers or people looking to build their dream home in a perfect position. With an abundance of living areas, the home is well-maintained and versatile with easy-care surrounds, including a large, well-established fernery. Ideally placed on the high side of the street in a quiet cul de sac, located in a popular pocket of Kirrawee. Motivated vendor seeking offers for an immediate sale.

- * Four bedrooms plus study area with built-in desk
- * Multiple options for family living, both upstairs and downstairs
- * Functional kitchen with dishwasher and plenty of cupboard space

Type : House
Land Size : 588.1 sqm
View : <https://www.jreproperty.com.au/sale/nsw/sutherlandland/kirrawee/residential/house/7489086>



Luke Jeffree
02 9540 2222

[For full version visit the website](https://www.jreproperty.com.au)

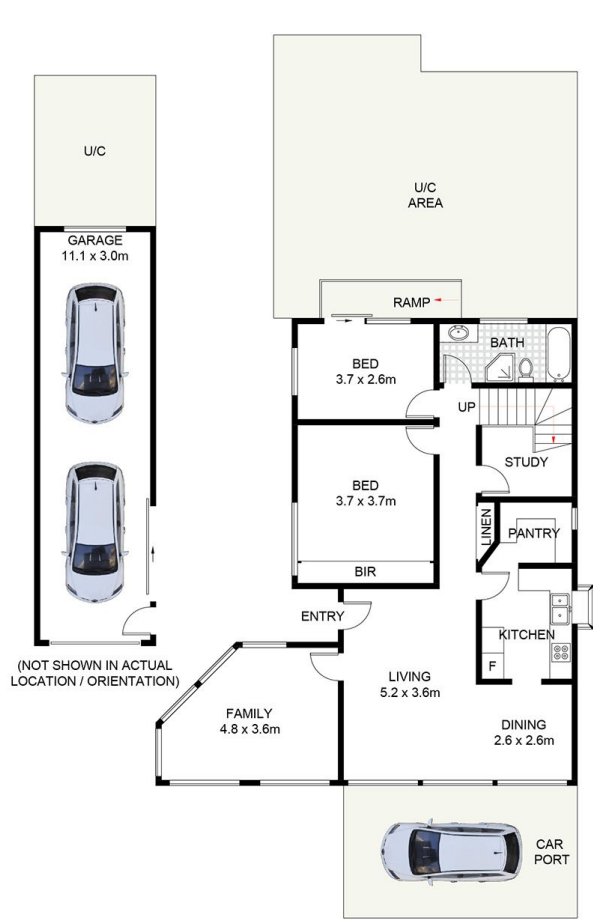

GROUND FLOOR



FIRST FLOOR

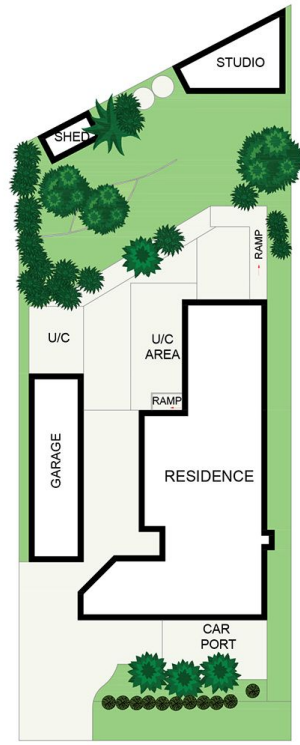

SITE PLAN
(NOT TO SCALE)



10 Bounty Avenue, Kirrawee

DISCLAIMER: PLANS SHOWN ARE FOR PRESENTATION PURPOSES AND ARE NOT PART OF ANY LEGAL DOCUMENT. ALL MEASUREMENTS AND FIGURES ARE APPROXIMATE.