



9/5-7 Koorabel Avenue GYMEA NSW

3 1 2

Enjoying a top floor position with 4.5 metre high ceilings resides this unique bright and airy apartment. Open plan with a clever designed second story mezzanine level with the flexibility for a fourth bedroom or another living area.

Enjoy a low maintenance lifestyle that comes with apartment living with plenty of storage space and all whilst being positioned conveniently in the heart of vibrant Gymea, close to transport and with all of Gymea's caf? culture and boutique shops at your doorstep.

- * Three bedrooms all with built in wardrobes
- * Spacious layout reveals combined lounge dining
- * Two large balconies capturing both morning & afternoon sun

Type : Unit

View : <https://www.jreproperty.com.au/sale/nsw/sutherland/gymea/residential/unit/7489090>



Trent Jeffree
02 9540 2222

[For full version visit the website](https://www.jreproperty.com.au)

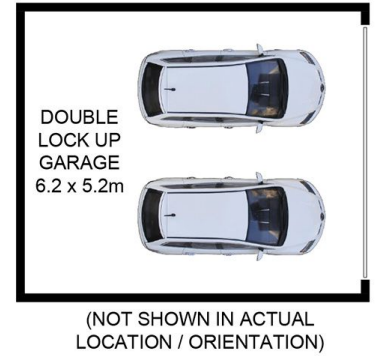
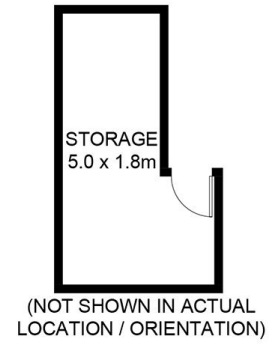
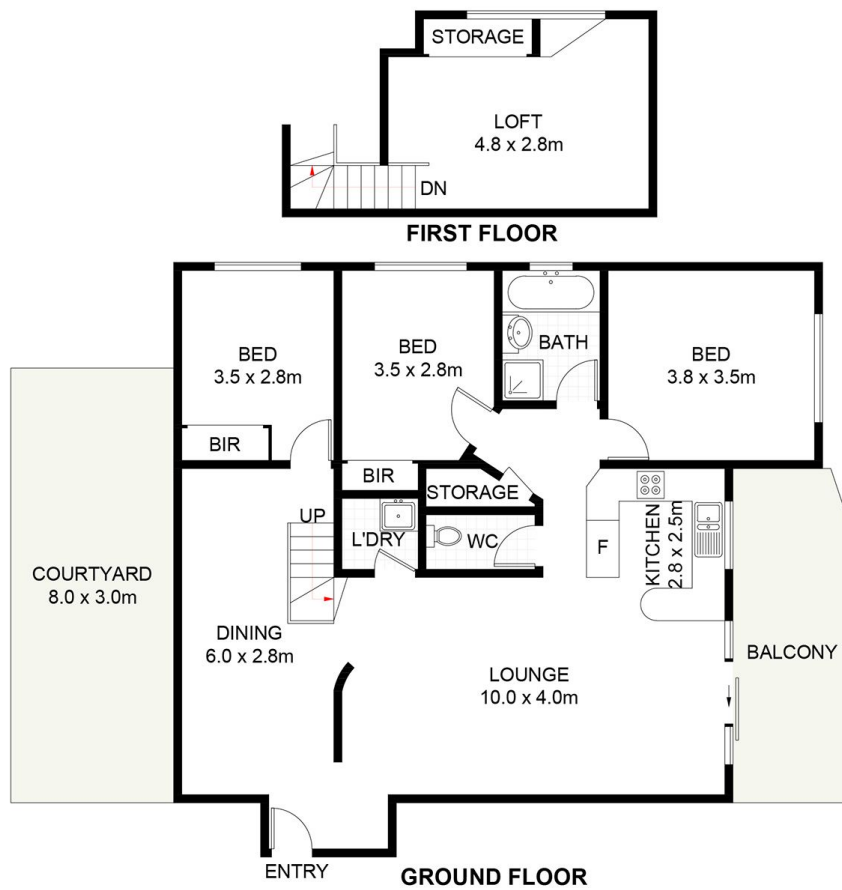

9/5-7 Koorabel Avenue, Gymea

DISCLAIMER: PLANS SHOWN ARE FOR PRESENTATION PURPOSES AND ARE NOT PART OF ANY LEGAL DOCUMENT. ALL MEASUREMENTS AND FIGURES ARE APPROXIMATE.