

18 Rival Street Kareela NSW

3 1 1

This inviting single level residence enjoys a sunny elevated position with a private and leafy outlook in a quality location. Easy care and well-maintained home whilst adding to its appeal is the sunny grassed yard which backs onto Kareela Primary school.

The home is well presented and ready for immediate comfort while also offering ample potential to make it a desirable place to call home. Located in close proximity to Kareela shops, cafes and restaurants.

- ? Timber floors, filled with natural light
- ? Spacious living & separate dining, air-con
- ? Three bedrooms, master with built in wardrobes

[For full version visit the website](https://www.jreproperty.com.au)

Type : House
Price : \$ 1,460,000
Land Size : 556.4 sqm
View : <https://www.jreproperty.com.au/sale/nsw/sutherland/kareela/residential/house/7629333>



Luke Jeffree
02 9540 2222



Belinda Sanders
02 9540 2222

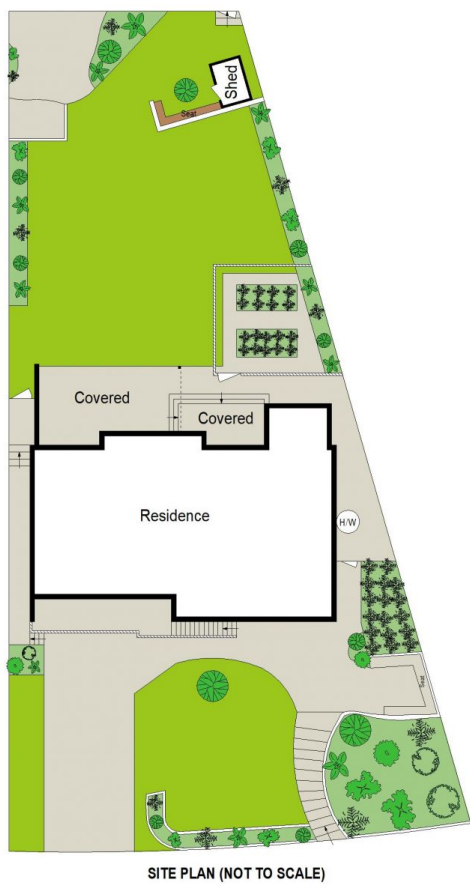

SITE PLAN (NOT TO SCALE)



GROUND FLOOR

LOWER GROUND FLOOR

JRE PROPERTY



18 Rival Street, Kareela

This diagram is for illustrative purpose only. All reasonable care has been taken in the preparation, but no warranty is given as to the accuracy of the information. This document does not constitute any part of any offer or contract. Dimensions shown are approximate only. Prospective purchasers must rely on their own enquiries.