



3/12-14 Kiora Road Miranda NSW

3 **2** **1**

Tucked away yet incredibly convenient, this first-floor apartment affords an easy-care lifestyle with amenities all at your door. An expansive living and dining area which leads out to the large balcony. Experience a low-maintenance lifestyle with a short stroll to Westfield Miranda, schools and restaurants.

Price : \$ 830,000

View : <https://www.jreproperty.com.au/sale/nsw/sutherland/miranda/residential/apartment/8016048>

- ? Bright and sunny aspect at the rear of the block
- ? Renovated kitchen with stone benches & Smeg appliances
- ? Open plan living and dining room with split system A/C
- ? Master bedroom with walk-in wardrobe and ensuite
- ? Generously sized 2nd and 3rd bedroom
- ? Extras include separate laundry, intercom entry, no common walls
- ? Single lock-up garage, security complex.



Trent Jeffree
02 9540 2222

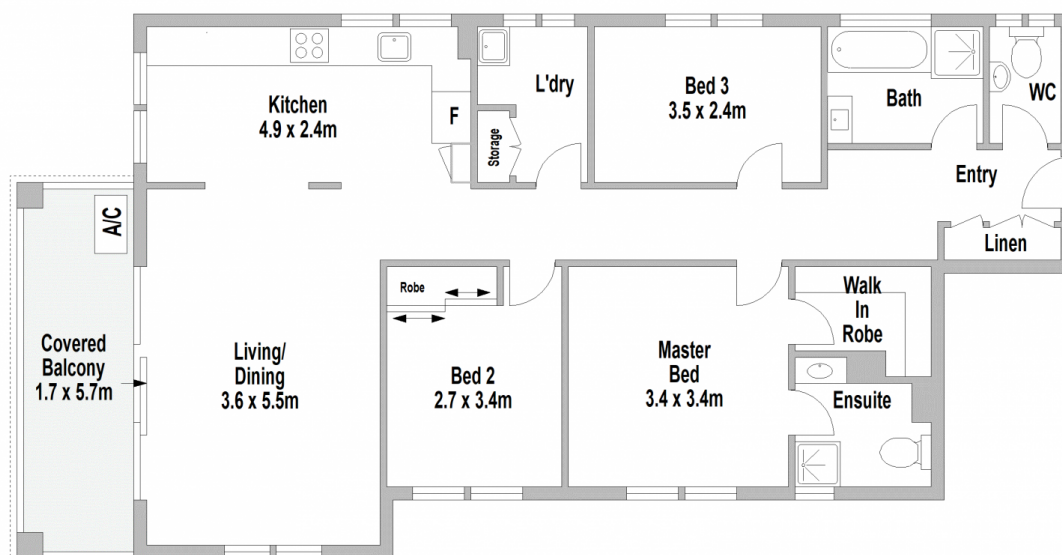

FIRST FLOOR

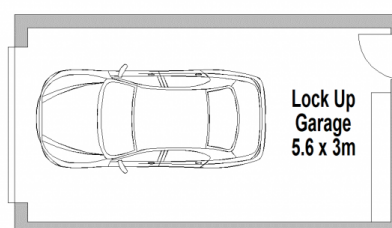

GROUND FLOOR

3/12-14 Kiara Road, Miranda



Scale in metres. Indicative only. Dimensions are approximate. All information contained herein is gathered from sources we believe to be reliable. However we cannot guarantee its accuracy and interested persons should rely on their own enquiries.