



19A North West Arm Road Gymea NSW

4 🛏 2 🚗 2 🚗

This stunning, newly constructed residence draws inspiration from Mediterranean architecture offering an exceptional blend of elegance and modern luxury.

The attention to detail throughout is unparalleled, with engineered timber flooring, exquisite stone and tiling choices and stunning ceiling voids creating a captivating sunlit atmosphere.

This thoughtfully designed four bedroom layout provides ample space for family living, working, or unwinding.

- ? Brand new build with premium finishes throughout and an elegant curving design
- ? Expansive open-plan living and dining areas that flow

Type : Semi Detached
Price : Guide \$2,000,000
View : <https://www.jreproperty.com.au/sale/nsw/sutherland/gymea/residential/semi-detached/8148688>



Trent Jeffree
02 9540 2222



Luke Jeffree
02 9540 2222

[For full version visit the website](https://www.jreproperty.com.au)



SITE PLAN (NOT TO SCALE)

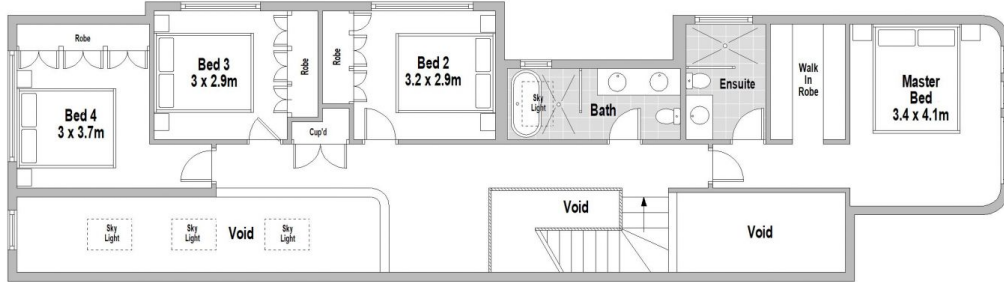

FIRST FLOOR

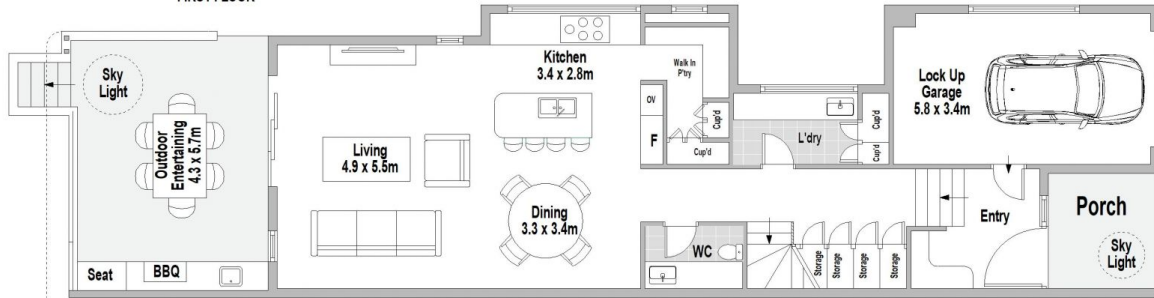

GROUND FLOOR

19a North West Arm Road, Gymea



Scale in metres. Indicative only. Dimensions are approximate. All information contained herein is gathered from sources we believe to be reliable. However we cannot guarantee its accuracy and interested persons should rely on their own enquiries.